

12-O-04

AN ORDINANCE

**Authorizing the City Manager to
Execute an Easement Agreement with
Harris Bank for an Aerial Easement for
Installation of a Clock at 1640 Maple Avenue**

WHEREAS, the City of Evanston ("Grantor") and Harris Bank ("Grantee") desire to enter into an Easement Agreement for installation of a clock at 1640 Maple which clock and its housing shall encroach on the public right-of-way; and

WHEREAS, the property located at 1640 Maple Avenue is a four-story commercial building; and

WHEREAS, said clock and its housing will be located over and above the west line of Maple Avenue and the south line of Church Street; and

WHEREAS, the clock and its housing are planned to be located as to encroach on the public right-of-way within a 5.69 foot section running east from the west property line of Grantee's property across the brick paver descending from a height of twenty feet ten inches at or near the west line of said brick pavers; and

WHEREAS, the City Council has determined that it is in the best interest of the City to enter into said Agreement,

NOW, THEREFORE BE IT ORDAINED BY THE CITY COUNCIL OF THE CITY OF EVANSTON, COOK COUNTY, ILLINOIS:

SECTION 1: That the City Manager is hereby authorized and directed to sign, and the City Clerk is hereby authorized and directed to attest on behalf of the City of

Evanston, an Easement Agreement, for the term of ninety-nine years and the sum of five hundred dollars (\$500.00) attached hereto as Exhibit A and made a part hereof, between the City of Evanston and Harris Bank providing for the installation of a clock at 1640 Maple Avenue.

SECTION 2: That the City Manager is hereby authorized and directed to negotiate any additional terms and conditions of the Agreement as may be determined to be in the best interests of the City.

SECTION 3: That this ordinance or parts of ordinance in conflict herewith are hereby repealed.

SECTION 4: That this ordinance shall be in full force and effect from and after its passage, approval, and publication in the manner provided by law.

Introduced: February 23, 2004

Adopted: March 8, 2004

Approved:

March 9, 2004

Lorraine H. Moxter
Mayor

ATTEST:

Mary J. Morris
City Clerk

APPROVED as to form:

[Signature]
Corporation Counsel

Ayes 9

Nays 0

EXHIBIT 'A'

PLAT OF EASEMENT

BY
SAMBORSKI, MATTIS, INC.
LAND SURVEYORS
4332 OAKTON STREET SKOKIE, ILL. 60076
(847) 674-7373
OF

THAT PART OF MAPLE AVENUE LYING EAST OF AND ADJOINING LOTS 1, 2, 3, 4, 5, 6, 7, AND 8 IN OWNER'S SUBDIVISION OF PARTS OF LOTS 1 AND 2 IN BLOCK 67 IN EVANSTON IN THE NORTHEAST QUARTER OF THE NORTHWEST QUARTER OF THE SOUTHWEST QUARTER OF SECTION 16, TOWNSHIP 41 NORTH RANGE 14 EAST OF THE THIRD PRINCIPAL MERIDIAN, DESCRIBED AS FOLLOWS: COMMENCING AT THE INTERSECTION OF THE WEST LINE OF MAPLE AVENUE AND THE SOUTH LINE OF CHURCH STREET; THENCE SOUTHEASTERLY ALONG THE WEST LINE OF MAPLE AVENUE 99.83 FEET TO THE POINT OF BEGINNING; THENCE NORTHEASTERLY AT RIGHT ANGLES TO SAID WEST LINE OF MAPLE AVENUE 5.69 FEET; THENCE SOUTHEASTERLY PARALLEL WITH THE WEST LINE OF MAPLE AVENUE, 7.04 FEET; THENCE SOUTHWESTERLY AT RIGHT ANGLES TO THE WEST LINE OF MAPLE AVENUE, 5.69 FEET TO THE WEST LINE OF MAPLE AVENUE; THENCE NORTHWESTERLY ALONG THE WEST LINE OF MAPLE AVENUE, 7.04 FEET MORE OR LESS TO THE POINT OF BEGINNING, IN COOK COUNTY, ILLINOIS. BOTTOM OF 4 SIDED CLOCK TO BE 20 FEET 10 INCHES ABOVE SIDEWALK PAVEMENT.



CHURCH STREET

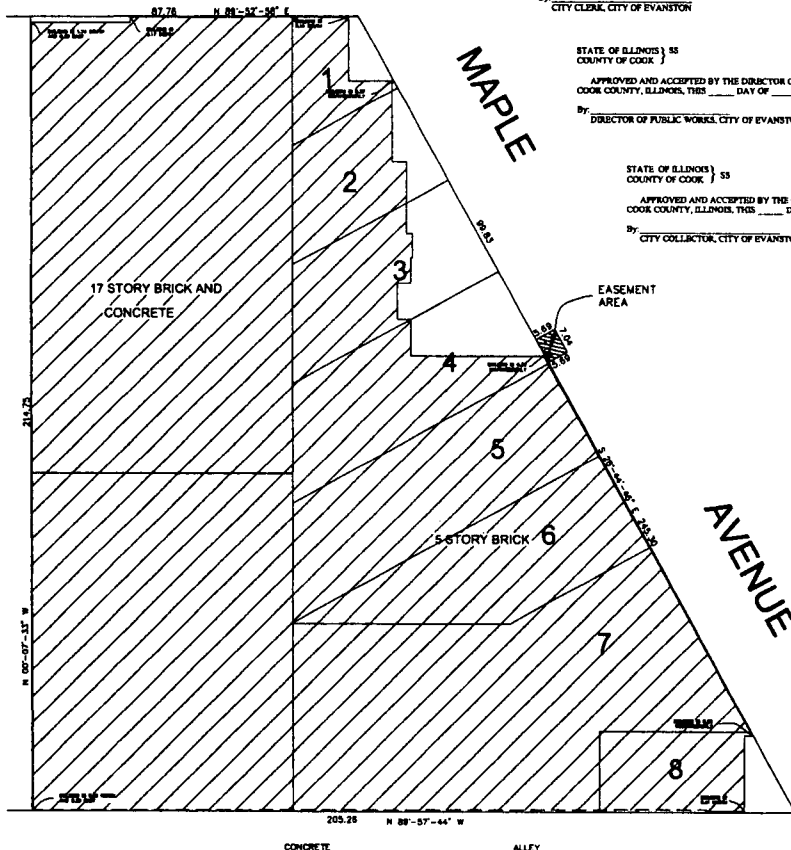

STATE OF ILLINOIS) SS
COUNTY OF COOK) SS

APPROVED AND ACCEPTED BY THE CITY COUNCIL OF THE CITY OF EVANSTON
COOK COUNTY, ILLINOIS, THIS ____ DAY OF _____, 200__

By: _____
CITY CLERK, CITY OF EVANSTON

STATE OF ILLINOIS) SS
COUNTY OF COOK) SS

APPROVED AND ACCEPTED BY THE DIRECTOR OF PUBLIC WORKS OF THE CITY OF EVANSTON
COOK COUNTY, ILLINOIS, THIS ____ DAY OF _____, 200__

By: _____
DIRECTOR OF PUBLIC WORKS, CITY OF EVANSTON

STATE OF ILLINOIS) SS
COUNTY OF COOK) SS

APPROVED AND ACCEPTED BY THE CITY COLLECTOR OF THE CITY OF EVANSTON
COOK COUNTY, ILLINOIS, THIS ____ DAY OF _____, 200__

By: _____
CITY COLLECTOR, CITY OF EVANSTON

SCALE: 1 inch = 20 feet

ORDER NO. 245-00 SIGN EASE

ORDERED BY: Parvin-Clause Sign Company

REVISED THIS 8th DAY OF JANUARY, A.D. 2004

STATE OF ILLINOIS) SS
COUNTY OF COOK) SS

I, MICHAEL J. MATTIS JR., DO HEREBY CERTIFY THAT I HAVE PREPARED THIS PLAT OF
EASEMENT FROM EXISTING RECORDS AND PLATS FOR THE PURPOSE OF GRANTING AN
EASEMENT AS SHOWN HEREON.

DATED THIS 13th DAY OF OCTOBER A.D. 2003

Michael J. Mattis Jr.
ILLINOIS PROFESSIONAL LAND SURVEYOR NO. 3227 LICENSE EXPIRES 11/02/2004
PROFESSIONAL LAND SURVEYING PERM NO. 044-000125 © SAMBORSKI MATTIS INC.



