

56-O-00

AN ORDINANCE

**Designating the Northeast Evanston
Historic District as an Evanston Historic District**

WHEREAS, Section 2-9-3, *et seq.* of the City Code of the City of Evanston has created the Evanston Preservation Commission; and

WHEREAS, among the powers of said Commission found in Section 2-9-3 (g) is the power and duty to investigate and make recommendations to the City Council or its duly authorized committee concerning the adoption of ordinances designating areas, properties, structures, sites and objects as landmarks and districts; and

WHEREAS, Section 2-9-4 of the City Code of the City of Evanston provides criteria for designation of nominated districts and requires that every district must meet one or more of the specified criteria for designation; and

WHEREAS, on October 19, 1999, the Northeast Evanston Historic District Association together with co-applicants Northwestern Neighbors Association and Save the Cottage Association presented to the Commission a nomination proposing the designation of a portion of Northeast Evanston as an Evanston Historic District; and

WHEREAS, pursuant to the provisions of the Evanston Preservation Commission Ordinance, the Preservation Commission held public hearings on said nomination on November 17, 1999 followed by hearings on December 1, 1999, December 14, 1999, January 13, 2000 and January 26, 2000. That at said hearings, the Commission considered testimony, and accepted written materials until February 1, 2000; and

WHEREAS, due notice of said hearings was given in accordance with the requirements of the Evanston Preservation Commission Ordinance and all persons desiring to be heard were given an opportunity to be heard; and

WHEREAS, after having heard and reviewed the nomination testimony, the written materials and all evidence adduced at said public hearings, the Commission made a written record and adopted a Resolution at its meeting on March 6, 2000, and determined that the nomination satisfied criterias two, three, five, and nine as set forth in the Ordinance and further found that the District had sufficient integrity of location, design, materials and workmanship to make it worthy of preservation or restoration, all as required by Section 2-9-4 (B) of said Ordinance; and

WHEREAS, the Commission specifically found that criteria two was satisfied in that the District meets the criteria of "its identification with a person or persons who significantly contributed to the historic, cultural, architectural, archeological or related aspects of the development of the City, state, midwester region or the United States"; and

WHEREAS, the Commission found that the nomination meet the requirements of criteria three which states "as exemplification of an architectural type, style or design, distinguished by innovation, rarity, uniqueness or overall quality of design, detail, materials or craftsmanship"; and

WHEREAS, the Commission found that the nomination met the provisions of criteria five, to-wit, "its exemplification of important planning and urban design techniques distinguished by innovation, rarity, uniqueness or overall quality of design or detail"; and

WHEREAS, the Commission found that the nomination met the requirements of criteria nine, to-wit, "its unique location or distinctive physical appearance or presence representing an established and familiar visual feature of a neighborhood, community or the City"; and

WHEREAS, the Commission further determined that the Northeast Evanston Historic District was truly important to the City of Evanston, its people, its culture and its history and met the criteria for designation as set forth in the Ordinance, and further recommended to the Mayor and City Council that the Northeast Evanston Historic District be designated as an Evanston Historic District; and

WHEREAS, on March 9, 2000, the Report and Recommendation of the Preservation Commission was submitted to the Planning and Development Committee of the City Council, which accepted same and submitted it to the City Council on March 13, 2000; and

WHEREAS, pursuant to direction of the City Council on March 13, 2000, the Planning and Development Committee held a public meeting on April 12, 2000, upon due notice and heard testimony from all persons desiring to be heard; and

WHEREAS, on April 24, 2000, the Planning and Development Committee considered the testimony received at its April 12, 2000 meeting and submitted the matter to City Council; and

WHEREAS, the City Council, at its May 8, 2000 meeting directed the Planning and Development Committee to consider modifications to the boundaries of the nominated Northeast Evanston Historic District; and

WHEREAS, the Planning and Development Committee held a public meeting on May 18, 2000, pursuant to due notice, receiving testimony, making a written record, and voting to recommend that the City Council modify the boundaries of the nominated Northeast Evanston Historic District; and

WHEREAS, said boundaries, as modified by the Planning and Development Committee on May 18, 2000, were further considered by the Committee at its May 22, 2000 meeting; and

WHEREAS, the Planning and Development Committee at the aforesaid May 18, 2000 public meeting, voted to recommend that the City Council modify the boundaries of the Northeast Historic District as nominated to the boundaries as set forth in Appendix A, more particularly described in Appendix B, both attached hereto and made a part hereof; and

WHEREAS, the City Council has considered the report and recommendation of the Evanston Preservation Commission, including the record made at said public hearings and has determined that the nomination, as modified by the Planning and Development Committee, for the Northeast Evanston Historic District meets the criteria and standards set forth in the City Code of the City of Evanston and the designation of said Historic District is in the best interests of the City of Evanston; and

WHEREAS, the City Council has determined the proceedings before the Evanston Preservation Commission were conducted and held in all respects according to law and the Planning and Development Committee proceedings were in accordance with City Council Rules; and

NOW, THEREFORE, BE IT ORDAINED BY THE MAYOR AND CITY COUNCIL OF
THE CITY OF EVANSTON: *Delete*

SECTION ONE: That the City Council hereby finds the foregoing as fact and accepts and adopts the Report and Recommendation of the Evanston Preservation Commission, both as accepted and later modified by the Planning and Development Committee at its May 18, 2000 meeting, that the Northeast Evanston Historic District be designated as a Historic District, as described in Appendix A, more particularly described in Appendix B. The Preservation Commission Report of March 6, 2000 is appended hereto and made part hereof as Exhibit C.

SECTION TWO: That the Northeast Evanston Historic District be and it is hereby established in accordance with the provisions of the Evanston Preservation Commission Ordinance, Title 2, Chapter 9 of the City Code. Title 2 Chapter 9, Schedule B is hereby amended to list by address all properties within the said Northeast Evanston Historic District. That the boundaries of said District are set forth in the aforescribed Appendix A and Appendix B.

SECTION THREE: That the provisions, conditions and requirements of the Evanston Preservation District Commission Ordinance shall apply to all properties located in the Northeast Evanston Historic District from and after the effective date of this Ordinance.

SECTION FOUR: All ordinances or parts of ordinances in conflict herewith are hereby repealed.

SECTION FIVE: That this ordinance shall be in full force and effect from and after its passage, approval and publication in pamphlet form in the manner provided by law.

AYES: 6

NAYS: 3

PASSED this 22nd day of May, 2000.

APPROVED this ___ day of _____, 2000.

Mayor

ATTEST:

Mary J. Morris
City Clerk

Approved as to form:

[Signature]
Corporation Counsel

PLANNING & DEVELOPMENT:

* Ordinance 67-O-00 – Amendment to Section 7-2-6(D) 5C of City Code – Consideration of proposed Ordinance 67-O-00, which would permit Council waiver of the use of certain nondisposable food service and packaging articles in sidewalk cafés. * MARKED INTRODUCED – CONSENT AGENDA

* Ordinance 73-O-00 – Amendments to City Code, Chapter 14 – Consideration of proposed Ordinance 73-O-00, which would amend Chapter 14 of the City Code, the Site Plan & Appearance Review regulations for sidewalk cafés. * MARKED INTRODUCED – CONSENT AGENDA

HUMAN SERVICES:

* Approval of Township Bills – Consideration of a recommendation that City Council approve the Township bills, payroll and medical payments for the month of May 2000 in the amount of \$102,335.08. * APPROVED – CONSENT AGENDA MOTION AND ROLL CALL (9-0)

* Special Event – Rotary International Picnic – Consideration of a request to hold the 7th annual Rotary International Staff Picnic on Friday, August 11, from 11:30 a.m. to 4:30 p.m. at Centennial Park. * APPROVED – CONSENT AGENDA MOTION AND ROLL CALL (9-0)

* Special Event – YMCA Indian Guides & Princesses Lakefront Campout – Consideration of a request to hold the annual Indian Guides & Princesses Lakefront Campout on September 23-24 in Centennial Park. * APPROVED – CONSENT AGENDA MOTION AND ROLL CALL (9-0)

* Special Event – City of Hope’s Walk for Hope – Consideration of a request to hold the 6th annual City of Hope Walk for Hope against breast cancer on Sunday, October 15, from 9:00 a.m. to noon at the lakefront, Centennial to Clark Square Park. * APPROVED – CONSENT AGENDA MOTION AND ROLL CALL (9-0)

* Ordinance 72-O-00 – Annual Budget for Evanston Township – Consideration of proposed Ordinance 72-O-00, by which City Council, acting as Township Trustees, would enact the annual appropriation ordinance for the Town of the City of Evanston for the FY 4/1/00-3/31/01. * MARKED INTRODUCED – CONSENT AGENDA

OTHER COMMITTEES:

* Resolution 62-R-00 – Amending Rule 9 of the City Council Rules and Organization – Consideration of proposed Resolution 62-R-00, which amends Rule 9 of the City Council Rules to create a City Council Budget Committee and assign responsibilities. * APPROVED – CONSENT AGENDA MOTION AND ROLL CALL (9-0)



Alderman Feldman moved to override Mayor Morton’s veto of Ordinance 56-O-00– Northeast Historic Preservation Ordinance adopted by the City Council on May 22, 2000. Seconded by Alderman Bernstein.

Alderman Engelman recalled when Council redrew boundaries, there was discussion of what support existed within those boundaries. He reiterated that no preservation program could succeed without the support of people within the district. No one went door to door so that every property owner could voice an opinion on the redrawn district, rather Council was presented with petitions from 40 within the district who supported it. Petitions opposing the district total 53 and about 65 had no opinion; 40 people out of 160 is 25%, hardly overwhelming support. He stated no district should

be enacted if it is not needed. He observed that not one residential home would be torn down for an institutional use in the R1 district if the Mayor's veto is sustained because the Zoning Ordinance prevents residential property in an R1 district from being turned into an institutional use. He suggested that the veto should be sustained for another reason. The community has said that they want the City Council to enter into negotiations with Northwestern University regarding a contribution. He did not believe it was good policy for Council, at the same time it asks the University to come to the table and enter into a dialogue, to send another message that was made by redrawing the boundary. This is not about preservation, but about Northwestern University and restrictions being imposed at the same time Council is asking them to engage in a dialogue on a contribution to the City and that would be inappropriate. He urged the Mayor's veto be sustained.

Alderman Newman asked First Assistant Corporation Counsel Herb Hill if any rule or procedure had been violated during the process of considering this ordinance? Mr. Hill said throughout the process, all City rules, procedures, guidelines, ordinance standards were followed. Special Counsel, Richard Friedman, was retained by the Preservation Commission during their review, who worked closely with Corporation Counsel Jack Siegel and the Law Department. Mr. Siegel and the Law Department were involved with drafting the ordinance. Alderman Newman asked about the ethics complaint? Mr. Hill stated a letter was written to the Mayor, which she forwarded to the Board of Ethics. The matter is set for consideration in the next week or so. There were 10-12 issues raised in the letter.

Alderman Newman stated 1st Ward people opposed to this ordinance were outnumbered by those who support it; noted matters on land use cannot be submitted to a plebiscite and balanced the interest of opponents versus proponents. For him a significant factor were the structures on Sheridan Road, which are not in a residential district but add to the residential character and beauty of the neighborhood and all of Evanston. These are structures that can or will go down unless Council has a voice. He noted every P&D Committee member was present at the May 22 meeting. Alderman Engelman made several suggestions, which were rejected. He found interesting the linkage to "Fair Share," and never knew of any interest by the Mayor in "Fair Share." He felt the people who worked on this ordinance deserved a hearing and to have their work voted up or down. He did not think it was in the City's interest to link it to other City business. He hoped Council would override the veto; was confident the community would flourish with this ordinance in place.

Alderman Feldman was content to listen to the 1st Ward alderman and the support he articulated, neighborhood organization support as well as letters and phone calls he received. He thought that was significant criteria that the district is wanted. He knows that it is needed. He stated the action taken at the last meeting caused anguish and struggle in many of the aldermen and was proud of the decision. They attempted to be Solomon-like and balance the needs with the values of the City. He was proud of the community people who struggled for passage of this ordinance. He urged his colleagues to override the veto, which he considered ill advised.

Mayor Pro Tem Rainey could not chastise anybody for dragging in the "Fair Share" issue. It never occurred to her that this would include a debate on "Fair Share" and heard it done in a clever way by both sides. When they look at the current Preservation Ordinance, when a new district is brought forth, she suggested a careful poll be taken of owners in that district. She saw preservation districts as a good goal, not a lofty goal. If a district were established where there is deteriorating housing and, by declaring it a historic district people wanted to come in and enhance property, she thought that a tool for improving the quality of housing. She was going to vote to override the veto because she did not think those who opposed it would be harmed in any way. She was concerned about the only multi-family apartment building in the district; stated the ordinance ought to address that and that building should have been eliminated from the district because it could pose hardships. She did not think NU would be harmed by this ordinance and believes so because of the Foster/Maple garage. She stated the prospect of a seven-story garage going into that neighborhood was unlikely. Yet this Council made that happen due to economic development, land swaps, etc. She thought given the ability of NU to get Council to agree to the possibility of a structure at that site, probably means it can do anything, in any kind of a district, anyplace in town. She does not support that. She never thought this local designation had anything to do with negotiations with NU. The University was not going to help the City anyway. She recalled asking for an engineer to help with the police outpost and NU refused. She hoped some member of the P&D Committee would refer the Preservation Ordinance for intense examination.

Roll Call. Voting aye – Newman, Wynne, Bernstein, Kent, Rainey, Feldman. Voting nay – Drummer, Moran, Engelman.
Motion carried (6-3).

Alderman Kent left the meeting at this time.

REPORT OF THE STANDING COMMITTEES

ADMINISTRATION & PUBLIC WORKS:

Resolution 43-R-00 – Parking Agreement with District #65 – Consideration of proposed Resolution 43-R-00, which authorizes the City Manager to execute an agreement with School District #65 for parking spaces in Lot 35 (Lincoln School).

Alderman Feldman moved approval. Seconded by Alderman Wynne.

Alderman Engelman asked who currently uses Lot #35 on the northeast corner of Judson and Main? Public Works Director David Jennings explained nighttime use is primarily residents (24-hour permits); daytime users are local businesses and their employees. Alderman Engelman asked the experience over the past two years on daytime permits? Mr. Jennings stated reasonably good, but not sold out. Mr. Jennings stated Lot #32 (east side Hinman, south of Main) and Lot #35 comprise the daytime permits. Alderman Wynne stated that Lot #35 has 55 spaces with 20 daytime permits sold there. The daytime permits allow parking in both lots #32 and #35. Alderman Engelman was concerned that they might be displacing one group of users for another. Mr. Jennings looked to see if there were enough vacancies in Lot #35 to accommodate 14 daytime parkers and there are. Alderman Wynne noted this is a wasting asset and they hope that teachers will park there instead of on the street.

Motion carried, no nays.

Ordinance 38-O-00 – Prohibit Immobilizing Vehicles – Consideration of proposed Ordinance 38-O-00, introduced May 8, 2000, by which City Council would prohibit private towing companies from immobilizing vehicles on private property.

Alderman Feldman moved approval of Ordinance 38-O-00. Seconded by Alderman Drummer.

Alderman Moran stated the City may want to regulate this activity; has heard from customers who have engaged this company that this is an effective regulatory tool and perhaps a more workable means of dealing with the problem it seeks to address. He recalled being towed in Chicago and how difficult the experience was. He noted Guardian Management Parking's flexibility toward this and that they brought the ordinance the Chicago City Council will vote on June 28. This ordinance does not prohibit booting in private lots, but provides a sensible regulatory framework. They learned from Mr. Hill at the A&PW Committee that the proposed ordinance was lifted from Chicago's current ordinance that prohibits booting. He thought that Chicago was going to do away with the flat-out prohibition of booting on private lots and work toward a regulatory scheme. He suggested they consider the pros and cons and, should they believe regulation is needed, take that action. He urged a "no" vote and to consider regulating this activity.

Alderman Drummer shared the feelings of Alderman Moran. He has concluded this is not the worst thing that can happen to Evanstonians and could be a positive experience. He noted this company remains on-site in the parking lots all day. If the vehicle is booted, there is someone there to remove the boot. Compared to the agony plus the cost of towing a vehicle, this is reasonable. He suggested they take another look at this ordinance and consider how to modify it. They heard from a citizen who had been booted and she was not angry, rather was pleased that she did not have to deal with a towing company. He noted Greatbank's president was cooperative and willing to have the City look at modifications that could affect his operation. One question was the amount of time between parking the car and the citizen going to another business. The president was willing to wait 15 minutes. This is 15 minutes out of somebody's private lot. He did not think it was as bad as towing which costs \$105 plus transportation and storage and the aggravation

Appendix A

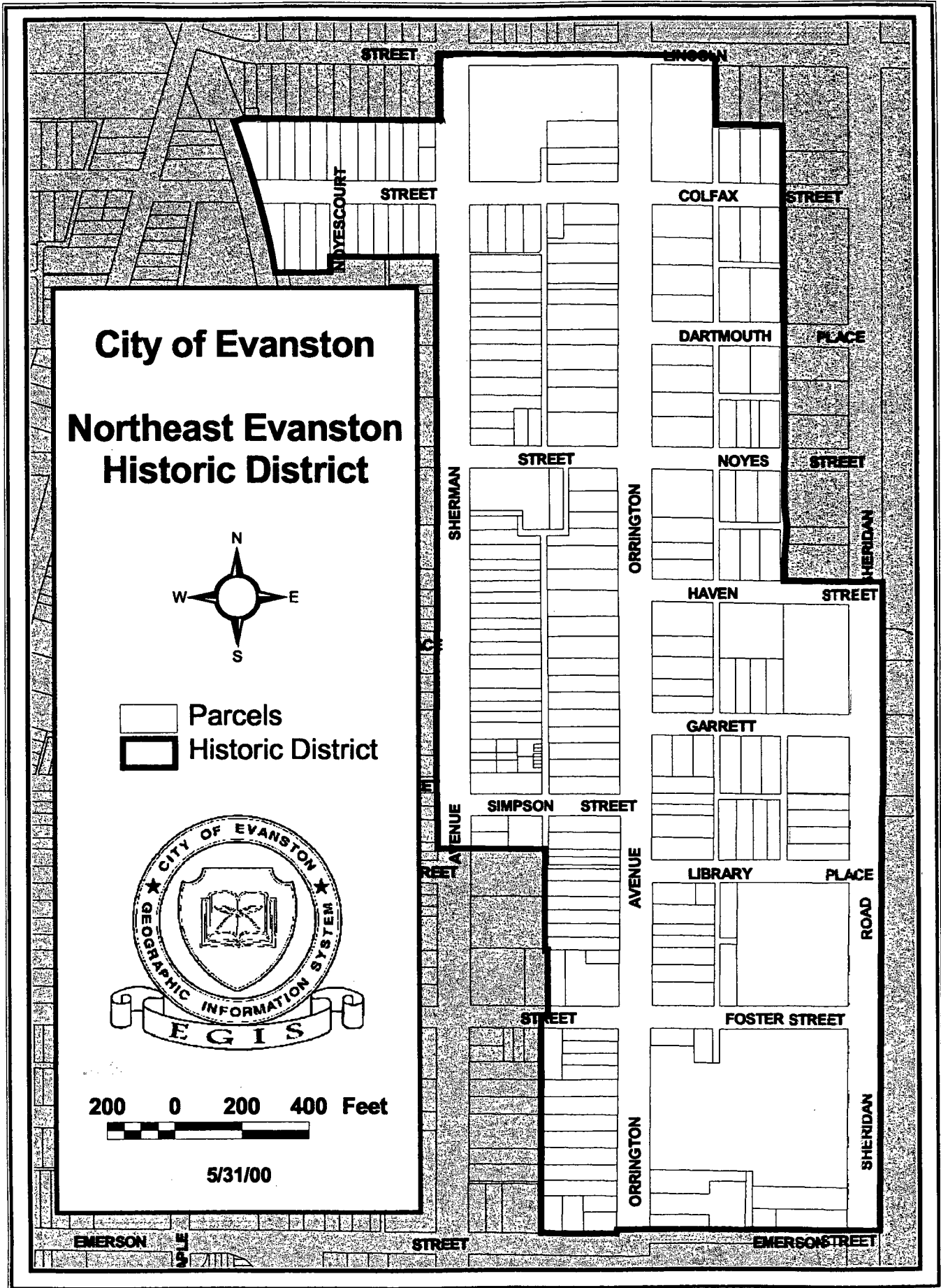

Appendix B

NORTHEAST EVANSTON HISTORIC DISTRICT BOUNDARIES

The boundaries of the Northeast Evanston Historic District are shown on Appendix A and are described verbally as follows:

Beginning at the intersection of the East right-of-way line of Sheridan Road and the North right-of-way line of Emerson Street; thence West along the north line of Emerson Street to the East line of the public alley West of Orrington Avenue; thence North along the East line of said public alley to the North line of Foster Street; thence East along the North line of Foster Street to the West line of 715 Foster Street; thence North along the West property line of 715 Foster Street to its intersection with the South property line of 2014 Orrington Avenue; thence West along the South property line of 2014 Orrington Avenue to the Southwest corner of said property; thence North along the West property lines of 2014 through 2030 Orrington Avenue to the Northwest property corner of 2030 Orrington Avenue; thence East along the North line of 2030 Orrington Avenue to its intersection with the east line of public alley; thence North along the east line of said public alley to a point which is 100 feet South of the South right-of-way line of Simpson Street; thence West at right angles to the last described course and along the South property line of 2039 Sherman Avenue, produced West, to the West line of Sherman Avenue; thence North along the West line of Sherman Avenue to the North line of the first public alley South of Colfax Street; thence West along the North line of said public alley (also being the South property line of 802 to 822 Colfax Street) to the East line of Noyes Court; thence South along said East line, extended South, a distance of 50.81 feet to its intersection with the Eastward extension of the South property lines of 828 to 908 Colfax Street; thence West along said Eastward extension and the South property lines of 828 to 908 Colfax Street to its intersection with the East line of the Chicago Transit Authority Elevated right-of-way line; thence Northwesterly along the said East line of the Chicago Transit Authority Elevated right-of-way line to its intersection with the South line of the public alley South of and parallel to Lincoln Street; thence East along said alley South line to the West line of the Sherman Avenue; thence North along said West line of Sherman Avenue to its intersection with the centerline of Lincoln Street; thence East along the centerline of Lincoln Street to the West line of the public alley East of Orrington Avenue; thence South along the West line of said public alley to its intersection with the South line of the public alley North of and parallel to Colfax Street; thence East along the South line of said public alley to its intersection with the West line of the vacated alley West of and parallel to Sheridan Road; thence South along the West line of said vacated alley extended South to its intersection with the North line of Haven Street; thence East along the North line of Haven Street to its intersection with the East line of Sheridan Road; thence South along the East line of Sheridan Road to the point of beginning.

**CITY OF EVANSTON
EVANSTON PRESERVATION COMMISSION**

A RESOLUTION

**Requesting the City Manager to Transmit
The Evanston Preservation Commission's Recommendation and Report
that the City Council Designate the Northeast Evanston Historic District
as an Evanston Historic District**

WHEREAS, On October 19, 1999 The Northeast Evanston Historic District Association ("NEHDA") along with co-applicants, Northwestern Neighbors and Save the Cottage Association (collectively, "Applicants"), presented to the Evanston Preservation Commission (the "Commission") a nomination (the "Nomination") proposing the designation of a portion of Northeast Evanston as a Local Evanston Historic District; and

WHEREAS, in accordance with the Historic Preservation Ordinance (Section 2-9-1 et seq. of the Municipal Code) (the "Ordinance") the Commission began a review process; and

WHEREAS, pursuant to the Ordinance, the Commission notified property owners of the receipt of the nomination; and

WHEREAS, thereafter the Commission scheduled a public hearing. The public hearing commenced on November 17, 1999, and it was continued on December 1, 1999, December 14, 1999, January 13, 2000, and January 26, 2000; and

WHEREAS, the Commission accepted written materials until February 1, 2000 at the close of the public hearing; and

WHEREAS, on February 1, 2000 and February 8, 2000, the Commission deliberated and evaluated the Nomination, testimony heard at the public hearing and written materials; and

NOW, THEREFORE, BE IT RESOLVED BY THE EVANSTON PRESERVATION COMMISSION OF THE CITY OF EVANSTON, COOK COUNTY, ILLINOIS:

Section 1: The Commission determines that the proposed Northeast Evanston Historic District is found to be in conformity with criteria in Section 2-9-4 (A) 2, 3, 5, 9 and item 2-9-4(B).

Section 2: The Commission recommends that the City Council designate the Northeast Evanston Historic District as an Evanston Historic District.

Section 3: The report of the Commission's findings is approved in substantially the form of the preliminary report submitted to this meeting. The Chair and the Preservation Coordinator may make such corrections and modifications thereto without change in substance as they shall deem appropriate, consistent with this resolution.

Section 4: The City Manager is hereby requested to transmit the Commission's Recommendation and Report to the Mayor and the City Council, within five business days hereof.

Section 5: The Preservation Coordinator shall send the report upon property owners in accordance with Section 2-9-5 (F) of the Ordinance.

Section 6: That this Resolution shall be in full force and effect from and after the date of its passage and approval in the manner required by law.

Adopted: 3-6, 2000, Yeas 8, Nays 0



J. Kirk Irwin
Evanston Preservation Commission Chair

ATTEST:

 03-06-00

George Halik
Secretary

NORTHEAST EVANSTON HISTORIC DISTRICT

Title 2 Chapter 9, Scheduled B (Addendum)				
Northeast Evanston Historic District - List by address of all properties				
C = Contributing Structure ; NC = Non-Contributing Structure				
Number	Street	Building Type	Date	Status
		Single Family/ Other		Contributing/ Non-Contributing
619	Colfax Street	S.F. (dorm)	1912	C
624	Colfax Street	S.F.	1915	C
625	Colfax Street	S.F. (office)	1910	C
628	Colfax Street	S.F.	1916	C
628	Colfax Street	Play House	1917	C
628	Colfax Street	Garage	unk	NC
629	Colfax Street	S.F.	1907	C
629	Colfax Street	Garage	1962	NC
714	Colfax Street	S.F.	1908	C
714	Colfax Street	Garage	mov. 1948	C
720	Colfax Street	S.F.	1917	C
720	Colfax Street	Garage	1973	NC
724	Colfax Street	S.F.	1906	C
724	Colfax Street	Garage	1925	C
725	Colfax Street	Dormitory	1963	NC
728	Colfax Street	S.F.	1907	C
728	Colfax Street	Garage	1983	NC
732	Colfax Street	S.F.	1907	C
732	Colfax Street	Garage	1998	NC
735	Colfax Street	S.F.	1935	C
802	Colfax Street	S.F.	1908	C
802	Colfax Street	Garage	1964	NC
805	Colfax Street	S.F.	1916	C
806	Colfax Street	S.F.	1908	C
806	Colfax Street	Garage	1976	NC
807	Colfax Street	S.F.	1907	C
807	Colfax Street	Garage	1940	C
810	Colfax Street	S.F.	1908	C
810	Colfax Street	Shed	1928	C
811	Colfax Street	S.F.	1907	C
811	Colfax Street	Garage	1911	C
812	Colfax Street	S.F.	1908	C
812	Colfax Street	Garage	1912	C
815	Colfax Street	S.F.	1907	C
815	Colfax Street	Garage	1931	C
818	Colfax Street	S.F.	1908	C
818	Colfax Street	Garage	1910	C
819	Colfax Street	S.F.	1908	C
819	Colfax Street	Garage	1921	C
822	Colfax Street	S.F.	1908	C
822	Colfax Street	Garage	1918	C
823	Colfax Street	S.F.	1908	C
823	Colfax Street	Barn	1908	C
827	Colfax Street	S.F.	1911	C
827	Colfax Street	Garage	1940	C
828	Colfax Street	S.F.	1908	C

NORTHEAST EVANSTON HISTORIC DISTRICT

828	Colfax Street	Garage	1911	C
900	Colfax Street	S.F.	1908	C
900	Colfax Street	Barn	1909	C
901	Colfax Street	S.F.	1908	C
901	Colfax Street	Garage	1990	NC
904	Colfax Street	S.F.	1908	C
904	Colfax Street	Barn	1909	C
905	Colfax Street	S.F.	1910	C
905	Colfax Street	Garage	1919	C
909	Colfax Street	S.F.	1909	C
909	Colfax Street	Garage	1923	C
911	Colfax Street	S.F.	1939	C
618-24	Colfax Street	S.F.	1915	C
618-24	Colfax Street	Garage	unk	C
617	Dartmouth Place	S.F. (office)	1909	C
617	Dartmouth Place	Garage	unk	C
620	Dartmouth Place	Parking Lot		NC
627	Dartmouth Place	S.F. (office)	1909	C
627	Dartmouth Place	Garage	1915	C
630	Dartmouth Place	S.F. (office)	1925	C
619	Emerson Street	S.F. (office)	1922	C
633	Emerson Street	Student Health Center	1960	NC
711	Emerson Street	S.F.	1890	C
711	Emerson Street	Garage	unk	C
717	Emerson Street	Apt.	1964	NC
600	Foster Street	Offices	1999	NC
617	Foster Street	Student Recreation Center	1973	NC
629	Foster Street	Religious Center	1999	NC
634	Foster Street	S.F.	1870	C
709	Foster Street	S.F.	1880	C
715	Foster Street	S.F.	1911	C
714-16	Foster Street	Apt.	1901	C
618	Garrett Place	S.F. (office)	1914	C
618	Garrett Place	Garage	1916	C
624	Garrett Place	S.F.	1916	C
624	Garrett Place	Garage	1924,1945	C
625	Garrett Place	S.F.	1924	C
625	Garrett Place	Garage	1940	C
628	Garrett Place	S.F.	1912	C
628	Garrett Place	Garage	1939	C
629	Garrett Place	2-Flat	1916	C
629	Garrett Place	Garage	1917,1945	C
632	Garrett Place	S.F.	1921	C
632	Garrett Place	Garage	1987	NC
638	Garrett Place	S.F.	1921	C
601-15	Garrett Place	Student Apartments	1959	NC
621-23	Garrett Place	Student Apartments	1961	NC
600	Haven Street	ffices, Library, Dormitory,	1929	C
600	Haven Street	Wheeler Hall Addition	1955	NC
612	Haven Street	Dormitory	1955	NC
617	Haven Street	S.F. (office)	1911	C
625	Haven Street	S.F. (office)	1914	C

NORTHEAST EVANSTON HISTORIC DISTRICT

625	Haven Street	Garage	1919	C
629	Haven Street	S.F.	1913	C
629	Haven Street	Garage	unk	NC
638-40	Haven Street	Double House	1963	NC
617	Library Place	S.F. (office)	1894	C
618	Library Place	Offices	1993	NC
619	Library Place	2-Flat	1915	C
619	Library Place	Coach House	1917	C
620	Library Place	S.F. (office)	1903	C
625	Library Place	S.F.	1921	C
625	Library Place	Garage	1966	NC
626	Library Place	S.F. (office)	1896	C
627	Library Place	S.F.	1894	C
627	Library Place	Garage	1937	C
628	Library Place	Apt.	1971	NC
630	Library Place	S.F.	1927	C
637-43	Library Place	Apt.	1913	C
637-43	Library Place	Garage	1929	C
640	Lincoln Street	School	1915	C
616	Noyes Street	S.F. (office)	1900	C
617	Noyes Street	S.F. (office)	1912	C
617	Noyes Street	Garage	1927	C
624	Noyes Street	S.F.	1902	C
624	Noyes Street	Garage	1945	C
625	Noyes Street	S.F. (office)	1898	C
629	Noyes Street	S.F. (office)	1912	C
719	Noyes Street	S.F.	1898	C
719	Noyes Street	Garage	1911	C
725	Noyes Street	S.F.	1898	C
725	Noyes Street	Garage	1926	C
718-34	Noyes Street	Co-op Apt.	1927	C
1900	Orrington Avenue	Apt.	1914	C
1906	Orrington Avenue	S.F.	1875	C
1906	Orrington Avenue	Garage	1967	NC
1910	Orrington Avenue	S.F.	1906	C
1910	Orrington Avenue	Garage	unk	C
1914	Orrington Avenue	S.F.	1895	C
1914	Orrington Avenue	Garage	1925	C
1915	Orrington Avenue	2-Flat	1916	C
1918	Orrington Avenue	S.F.	1890	C
1918	Orrington Avenue	Garage	1916	C
1922	Orrington Avenue	S.F.	1896	C
1922	Orrington Avenue	Barn	unk	C
1926	Orrington Avenue	S.F.	1890	C
1926	Orrington Avenue	Garage	unk	NC
1927	Orrington Avenue	Dormitory	1970	NC
1930	Orrington Avenue	S.F.	1890	C
1930	Orrington Avenue	Garage	1921	C
1934	Orrington Avenue	S.F.	1890	C
1934	Orrington Avenue	Garage	1924	C
1936	Orrington Avenue	S.F.	1894	C
1936	Orrington Avenue	Garage	1924	C

NORTHEAST EVANSTON HISTORIC DISTRICT

1940	Orrington Avenue	S.F.	1895	C
1940	Orrington Avenue	Garage	1925	C
1941	Orrington Avenue	S.F.	1941	C
1942	Orrington Avenue	S.F.	1895	C
1942	Orrington Avenue	Garage	1925	C
1945	Orrington Avenue	S.F.	1955	NC
1946	Orrington Avenue	S.F.	1895	C
1946	Orrington Avenue	Garage	unk	NC
2001	Orrington Avenue	Double House	1892	C
2005	Orrington Avenue	S.F.	1894	C
2005	Orrington Avenue	Garage	unk	NC
2010	Orrington Avenue	S.F.	1890	C
2010	Orrington Avenue	Garage	1936	C
2011	Orrington Avenue	S.F.	1922	C
2011	Orrington Avenue	Garage	1922	C
2014	Orrington Avenue	2-Flat	1903,1960s	NC
2015	Orrington Avenue	S.F.	1910	C
2015	Orrington Avenue	Coach House	1910	C
2018	Orrington Avenue	S.F.	1890	C
2018	Orrington Avenue	Garage	1920	C
2019	Orrington Avenue	S.F.	1905	C
2019	Orrington Avenue	Garage	unk	C
2020	Orrington Avenue	S.F.	1885	C
2020	Orrington Avenue	Garage	unk	NC
2023	Orrington Avenue	S.F.	1978	NC
2023	Orrington Avenue	Garage	1978	NC
2024	Orrington Avenue	S.F.	1880	C
2026	Orrington Avenue	S.F.	1903	C
2026	Orrington Avenue	Garage	unk	C
2027	Orrington Avenue	S.F.	1875	C
2027	Orrington Avenue	Garage	1997	NC
2030	Orrington Avenue	S.F.	1903	C
2030	Orrington Avenue	Garage	unk	C
2032	Orrington Avenue	Garage	unk	NC
2034	Orrington Avenue	Garage	unk	NC
2036	Orrington Avenue	S.F.	1905	C
2036	Orrington Avenue	Garage	unk	C
2036	Orrington Avenue	Garage	unk	NC
2039	Orrington Avenue	S.F.	1900	C
2039	Orrington Avenue	Garage	1922	C
2040	Orrington Avenue	S.F.	1905	C
2040	Orrington Avenue	Garage	unk	C
2043	Orrington Avenue	S.F.	1928	C
2043	Orrington Avenue	Garage	1928	C
2047	Orrington Avenue	S.F.	1928	C
2047	Orrington Avenue	Garage	1928	C
2102	Orrington Avenue	S.F.	1890	C
2102	Orrington Avenue	Garage	unk	C
2103	Orrington Avenue	S.F.	1895	C
2103	Orrington Avenue	Garage	1924	C
2106	Orrington Avenue	S.F.	1895	C
2106	Orrington Avenue	Garage	1924	C

NORTHEAST EVANSTON HISTORIC DISTRICT

2110	Orrington Avenue	S.F.	1898	C
2110	Orrington Avenue	Garage	1985	NC
2111	Orrington Avenue	S.F.	1921	NC
2112	Orrington Avenue	S.F.	1893	C
2112	Orrington Avenue	Garage	1990	NC
2112	Orrington Avenue	Garage	unk	C
2118	Orrington Avenue	S.F.	1899	C
2118	Orrington Avenue	Garage	1918	C
2118	Orrington Avenue	Garage	unk	NC
2121	Orrington Avenue	S.F.	1909	C
2121	Orrington Avenue	Garage	1922	C
2122	Orrington Avenue	S.F.	1909	C
2122	Orrington Avenue	Garage	1922	C
2126	Orrington Avenue	S.F.	1890	C
2126	Orrington Avenue	Garage	1953	NC
2127	Orrington Avenue	S.F.	1903	C
2127	Orrington Avenue	Garage	1966	NC
2130	Orrington Avenue	S.F.	1915	C
2130	Orrington Avenue	Garage	unk	NC
2131	Orrington Avenue	S.F.	1965	NC
2131	Orrington Avenue	Garage	1966	NC
2134	Orrington Avenue	S.F.	1911	C
2134	Orrington Avenue	Garage	1972	NC
2135	Orrington Avenue	S.F.	1902	C
2135	Orrington Avenue	Garage	1913	C
2138	Orrington Avenue	Garage	1920	C
2138	Orrington Avenue	S.F.	1921	C
2145	Orrington Avenue	Double House	1963	NC
2146	Orrington Avenue	S.F.	1912	C
2146	Orrington Avenue	Garage	1920	C
2203	Orrington Avenue	S.F.	1895	C
2203	Orrington Avenue	Garage	1979	NC
2204	Orrington Avenue	S.F.	1899	C
2204	Orrington Avenue	Garage	1904	C
2206	Orrington Avenue	S.F.	1912	C
2206	Orrington Avenue	Coach House	1917	C
2207	Orrington Avenue	S.F.	1900	C
2207	Orrington Avenue	Garage	1985	NC
2214	Orrington Avenue	S.F.	1919	C
2215	Orrington Avenue	S.F.	1900	C
2215	Orrington Avenue	Garage	1969	NC
2218	Orrington Avenue	S.F.	1919	C
2219	Orrington Avenue	S.F.	1923	C
2219	Orrington Avenue	Garage	1936	C
2222	Orrington Avenue	S.F.	1921	C
2233	Orrington Avenue	S.F.	1909	C
2233	Orrington Avenue	Garage	1937	C
2236	Orrington Avenue	S.F.	1895	C
2236	Orrington Avenue	Coach House	1906	C
2243	Orrington Avenue	S.F.	1892	C
2243	Orrington Avenue	Garage	1967	NC
2244	Orrington Avenue	S.F.	1906	C

NORTHEAST EVANSTON HISTORIC DISTRICT

2244	Orrington Avenue	Garage	1917	C
2246	Orrington Avenue	S.F.	1915	C
2246	Orrington Avenue	Garage	1917	C
2247	Orrington Avenue	Garage	1922	C
2247	Orrington Avenue	S.F.	1923	C
2252	Orrington Avenue	S.F.	1914	C
2252	Orrington Avenue	Coach House	1917	C
2255	Orrington Avenue	S.F.	1913	C
2255	Orrington Avenue	Garage	unk	C
2302	Orrington Avenue	S.F.	1925	C
2302	Orrington Avenue	Garage	1927	C
2306	Orrington Avenue	S.F.	1875	C
2306	Orrington Avenue	Coach House	1926	C
2306	Orrington Avenue	Garage	1993	NC
2307	Orrington Avenue	S.F.	1916	C
2307	Orrington Avenue	Coach House	1917	C
2314	Orrington Avenue	S.F.	1927	C
2315	Orrington Avenue	S.F.	1922	C
2315	Orrington Avenue	Garage	1924	C
2316	Orrington Avenue	S.F.	1905	C
2316	Orrington Avenue	Garage	1912	C
2316	Orrington Avenue	Garage	unk	NC
2320	Orrington Avenue	S.F.	1905	C
2320	Orrington Avenue	Garage	1998	NC
2323	Orrington Avenue	S.F.	1921	C
2323	Orrington Avenue	Garage	unk	C
2326	Orrington Avenue	S.F.	1908	C
2326	Orrington Avenue	Garage	unk	NC
2330	Orrington Avenue	S.F.	1908	C
2330	Orrington Avenue	Garage	1921	C
2331	Orrington Avenue	S.F.	1919	C
2340	Orrington Avenue	S.F.	1905	C
2344	Orrington Avenue	S.F.	1908	C
2344	Orrington Avenue	Garage	1919	C
2408	Orrington Avenue	School	1907	C
2001-03	Orrington Avenue	Garage	1925	C
2032-34	Orrington Avenue	Double House	1894	C
1902	Sheridan Road	S.F. (office)	1901	C
1908	Sheridan Road	S.F. (office)	1892	C
1914	Sheridan Road	S.F. (office)	1884	C
1918	Sheridan Road	S.F. (office)	1922	C
1922	Sheridan Road	S.F. (office)	1911	C
1936	Sheridan Road	S.F. (office)	1893	C
1940	Sheridan Road	S.F. (office)	1894	C
2000	Sheridan Road	S.F. (office)	1921	C
2006	Sheridan Road	S.F. (office)		C
2010	Sheridan Road	S.F. (office)	1917	C
2016	Sheridan Road	S.F. (office)	1893	C
2036	Sheridan Road	Vacant Land		C
2040	Sheridan Road	S.F. (office)	1905	C
2040	Sheridan Road	Garage		C
2044	Sheridan Road	S.F.	1901	C

NORTHEAST EVANSTON HISTORIC DISTRICT

2044	Sheridan Road	Garage		C
2046	Sheridan Road	S.F. (office)	1910	C
2110	Sheridan Road	Religious Center	1967	NC
2039	Sherman Avenue	2-Flat	1909	C
2043	Sherman Avenue	S.F.	1894	C
2107	Sherman Avenue	Town House	1972	NC
2109	Sherman Avenue	Town House	1972	NC
2111	Sherman Avenue	Town House	1972	NC
2115	Sherman Avenue	S.F.	1900	C
2115	Sherman Avenue	Garage	unk	C
2115	Sherman Avenue	Garage	unk	C
2119	Sherman Avenue	S.F.	1895	C
2119	Sherman Avenue	Garage	unk	NC
2123	Sherman Avenue	S.F.	1895	C
2123	Sherman Avenue	Garage	unk	NC
2125	Sherman Avenue	S.F.	1895	C
2125	Sherman Avenue	Garage	unk	C
2129	Sherman Avenue	S.F.	1896	C
2129	Sherman Avenue	Garage	unk	C
2131	Sherman Avenue	S.F.	1893	C
2131	Sherman Avenue	Garage	unk	C
2135	Sherman Avenue	S.F.	1894	C
2135	Sherman Avenue	Garage	unk	NC
2137	Sherman Avenue	S.F.	1894	C
2137	Sherman Avenue	Garage	unk	C
2141	Sherman Avenue	2-Flat	1905	C
2141	Sherman Avenue	Garage	unk	NC
2145	Sherman Avenue	2-Flat	1905	C
2145	Sherman Avenue	Garage	unk	C
2147	Sherman Avenue	S.F.	1895	C
2147	Sherman Avenue	Garage	unk	C
2149	Sherman Avenue	S.F.	1895	C
2149	Sherman Avenue	Garage	unk	C
2151	Sherman Avenue	S.F.	1895	C
2151	Sherman Avenue	Garage	unk	C
2201	Sherman Avenue	S.F.	1915	C
2201	Sherman Avenue	Garage	1920	C
2205	Sherman Avenue	S.F.	1913	C
2205	Sherman Avenue	Garage	1928	C
2207	Sherman Avenue	S.F.	1901	C
2207	Sherman Avenue	Garage	1925	C
2211	Sherman Avenue	S.F.	1901	C
2211	Sherman Avenue	Garage	1995	NC
2233	Sherman Avenue	S.F.	1899	C
2233	Sherman Avenue	Garage	1997	NC
2235	Sherman Avenue	S.F.	1899	C
2237	Sherman Avenue	S.F.	1898	C
2237	Sherman Avenue	Garage	unk	C
2241	Sherman Avenue	S.F.	1905	C
2241	Sherman Avenue	Garage	unk	C
2249	Sherman Avenue	S.F.	1900	C
2249	Sherman Avenue	Garage	unk	NC

NORTHEAST EVANSTON HISTORIC DISTRICT

2253	Sherman Avenue	S.F.	1901	C
2253	Sherman Avenue	Garage	unk	NC
2301	Sherman Avenue	S.F.	1911	C
2301	Sherman Avenue	Garage	unk	C
2305	Sherman Avenue	S.F.	1907	C
2305	Sherman Avenue	Garage	unk	NC
2309	Sherman Avenue	S.F.	1904	C
2309	Sherman Avenue	Garage	unk	C
2311	Sherman Avenue	S.F.	1904	C
2311	Sherman Avenue	Garage	unk	NC
2315	Sherman Avenue	S.F.	1907	C
2315	Sherman Avenue	Garage	unk	NC
2319	Sherman Avenue	S.F.	1907	C
2319	Sherman Avenue	Garage	1950	NC
2346	Sherman Avenue	S.F.	1916	C
2346	Sherman Avenue	Garage	1919	C
2351	Sherman Avenue	S.F. (office)	1941	C
718-24	Simpson Street	Apt.	1909	C
721-31	Simpson Street	Apt.	1916	C

City of Evanston

Evanston Preservation Commission

**Report to the City Council
Recommendation that the Northeast Evanston Historic District
be Designated as an Evanston Historic District**

March 6, 2000

To the Honorable Mayor and the City Council of the City of Evanston:

Ladies and Gentlemen:

The Evanston Preservation Commission, having completed its deliberations, has determined that the Northeast Evanston Historic District should be designated as an Evanston Historic District. Pursuant to Section 2-9-4 of the City Code of the City of Evanston, the Evanston Preservation Commission recommends that the City Council designate said district as an Evanston Historic District, and in support of this recommendation, the Preservation Commission submits the following report.

PROCEDURAL HISTORY

On October 19, 1999 The Northeast Evanston Historic District Association, along with co-applicants, Northwestern Neighbors Association and Save the Cottage Association, presented to the Evanston Preservation Commission (the "Commission") a Nomination (the "Nomination") proposing the designation of a portion of Northeast Evanston as an Evanston Historic District. In accordance with the Historic Preservation Ordinance (Section 2-9-1 et seq. of the Evanston City Code) (the "Ordinance") the Commission began a review process that included a public hearing. The Commission evaluated the Nomination, testimony heard at the public hearing and written submittals. The Commission has determined that the Northeast Evanston Historic District, the

boundaries of which are set forth on Appendix A, should be designated as an Evanston Historic District.

Pursuant to the Ordinance, the Commission notified property owners of the receipt of the Nomination. Thereafter, the Commission scheduled the public hearing. The public hearing commenced on November 17, 1999, and was continued on December 1, 1999, December 14, 1999, January 13, 2000, and January 26, 2000. The Commission accepted written materials until February 1, 2000. The Commission met in two sessions to deliberate upon the evidence, on February 1, 2000 and February 8, 2000.

The Commission reviewed the Nomination and all other testimony, including written and spoken testimony from all concerned parties. At a meeting held March 6, 2000, the Commission approved this report by a vote of eight in favor and none against. In addition to this report, the Commission submits herewith the following:

Appendix A. Boundary map of the proposed Northeast Evanston Historic District.

Appendix B. Designation of Contributing and Non-Contributing structures.

Appendix C. List of documents in the record of the proceedings, including Nomination, transcripts of hearings and meetings, notices and certificates of mailings and written materials received and made part of the record. [The record is available for public inspection at the office of the City Clerk and the Preservation Coordinator.]

CRITERIA

The Ordinance outlines a specific procedure by which nominated landmarks and or districts shall be taken under consideration. The Ordinance requires that a district have definable boundaries and that the buildings comprising the district be classified as contributing or non-contributing structures depending upon their physical characteristics.

The Ordinance states that the proposed district must meet at least one of the ten criteria for designation listed in Section 2-9-4(A). In addition, the Ordinance states that the district must also agree with Section 2-9-4(B); sufficient integrity of location, design, materials and workmanship to make it worthy of preservation or restoration.

The district is found to be in conformity with criteria 2, 3, 5, 9, and item (B). The significance of the district will be described in relation to each of these criteria.

Criterion 2

Criterion 2 states: "Its identification with a person or persons who significantly contributed to the historic, cultural, architectural, archaeological or related aspect of the development of the City, State, Midwest region or the United States."

The Nomination lists several persons who contributed to these aspects of the development of the city, state, region, or country. The Nomination lists many architects associated with the district whose work is of national merit, including Thomas Eddy Tallmadge and Vernon S. Watson, Ernest A. Mayo, George W. Maher, Myron Hunt, William Holabird, Robert Steely DeGolyer, Howard Van Doren Shaw and Dwight Perkins. Prominent architects who lived in Evanston and designed houses in the Northeast Evanston Historic District include Charles Robert Ayars, Edgar Ovet Blake, and Stephen A. Jennings, among others.

The district is identified with many local persons who influenced the development of the city and region, including, Thomas B. Carson, Charles A. Hemphill, Carl W. Johnson, S. S. Neal, James T. Tait, and James Wigginton, among others.

The 1915 Blue Book lists 260 residents of whom some were university professors, doctors, lawyers and business people who lived in the district. Some of the

residents include Florence Walrath, founder and first managing director of the Cradle, Walter Dill Scott, Northwestern University president, Catherine Waugh McCulloch, first woman nominated to the electoral college, Edgar Kirk Warren, major contributor to the 1917 Plan for Evanston, and William Andrew Dyche, elected alderman of the Seventh Ward in the first city election in 1892 and elected mayor in 1895.

Criterion 3

Criterion 3 states: "Its exemplification of an architectural type, style or design distinguished by innovation, rarity, uniqueness or overall quality of design, detail, materials or craftsmanship."

Buildings in the district are predominantly of the residential type. They exemplify exceptional quality in their design, detail, materials and craftsmanship. Within this singular building type there are many architectural expressions illustrated in designs by several significant architects. The buildings within the district are of a consistent high quality, well detailed and well designed, and are well executed through exceptional craftsmanship. Examples of this include, but are not limited to, 714 and 708 Milburn Street. 714 Milburn Street is a Prairie Style house designed by Ernest Mayo. Examples of its quality design are seen in the design of the entry portico with a trellis and the arch over the center window on the upper level. The house immediately to the east, 708 Milburn Street, is a Georgian Revival house of nearly the same size and scale of 714 Milburn Street. It is also executed in an exceptional manner.

Other similar examples of fine craftsmanship and design include 715 Monticello Place, 806 Ingleside Place, and 2235 Sherman Avenue, to name a few. An example of fine craftsmanship and innovative development is the Milburn Park development dating

from 1937.

The Commission noted that an overwhelming number of homes in the district have had very few alterations made to them as seen from the public way, thereby maintaining much of their original characteristics and quality workmanship.

In general, the homes in the district convey a strong sense of architectural integrity. An overwhelming number of homes in the district were listed as contributing structures. The homes in the district are exemplary of the stylistic variety of homes typically built between the 1890's and 1940's in a prosperous area.

Criterion 5

Criterion 5 states: "Its exemplification of important planning and urban design techniques distinguished by innovation, rarity, uniqueness or overall quality of design or detail."

The Nomination lists several examples of urban planning techniques that were unique or innovative. The Nomination refers to the 1917 Plan for Evanston and the subsequent 1921 Zoning Ordinance that was the first in Illinois. Daniel H. Burnham Jr., Dwight Perkins and Thomas Eddy Tallmadge, all architects of national significance, were on the first Evanston Plan Commission. Burnham's father is the author of the Plan for the City of Chicago and several other city plans around the country including the Restoration of the Mall in Washington, DC, and the Plan for San Francisco. Burnham Jr. had a significant role in running Burnham and Company at the time of his involvement with the Evanston Plan. It was the 1917 Plan and the 1921 Zoning Ordinance that set the residential character of the District. It is rare and unique to have architects of the stature of Burnham, Tallmadge, and Perkins as contributing authors of the first Comprehensive

Plan for one's community.

Criterion 9

Criterion 9 states: "Its unique location or distinctive physical appearance or presence representing an established and familiar visual feature of a neighborhood, community or the City."

The district clearly represents visual features familiar and established within the City of Evanston through the significant number of high quality residential buildings. Such cohesiveness results from a consistency of size, scale, massing, detail, and quality workmanship. Criterion 9 also applies very directly to this district because the three broad parkways of Sherman Avenue, Orrington Avenue, and Sheridan Road with their one-hundred foot rights-of-way provide a distinct visual appearance to the district. In addition, it is the only area within Evanston to have three consecutive one hundred-foot rights-of-way.

ITEM (B) (INTEGRITY)

Item (B) states: "Integrity of Landmarks and Districts: Any area, property, structure, site or object that meets any one or more of the criteria in subsection 2-9-4(A) shall also have sufficient integrity of location, design, materials and workmanship to make it worthy of preservation or restoration."

The integrity of the district is characterized by houses having similar massing and scale and having a consistent street and alley pattern. The integrity of the District is strengthened by the relationship of buildings to streets and the streetscape itself. Another characteristic showing integrity throughout the district is the consistent pattern of main-house-and-outbuilding--usually a garage, but sometimes a coach house. What makes all

of this significant is the consistency of these characteristics within the boundaries of the district, the variety of stylistic expression within one building type, and the quality of the workmanship throughout.

The integrity and consistency of the district is not compromised, but is strengthened by different stylistic expressions. Examples of consistent of size, scale and mass within a multiplicity of stylistic expressions include; 733, 731, and 729 Lincoln Street. The house on the corner 733 Lincoln Street is listed as an American Four Square, but has some Prairie Style details. The middle house, 731 Lincoln Street, is classical with a Corinthian portico. The house at 729 Lincoln Street has a gabled front and is simply detailed. Although of differing styles, they relate to one-another in scale and massing.

The Commission determined that the district has integrity of location. The boundaries of the district are visually evident and clear. Furthermore, most of the buildings remain on their original sites. The district has integrity of design, materials, and workmanship as seen in a significant number of contributing buildings distributed consistently throughout the district. The criterion is met since there is a distribution of contributing buildings throughout the district and because of the high quality of landscaped settings which occur between the buildings.

CRITICAL FEATURES OF THE DISTRICT

Materials and Construction

The features critical to the district are represented by several exterior cladding materials including face brick veneer, clapboard wood siding, and stucco, with some stone masonry bearing wall construction. Most of the houses are made of wood framing and clad in a variety of materials. The institutional buildings include face brick cladding

at Kendall College, stone masonry construction at Seabury-Western Theological Seminary, and stucco veneer at the Roycemore School.

Residential and Institutional Buildings

The district is primarily residential in character with a few substantial institutional buildings placed within and alongside residential structures. Significantly, the institutional buildings are designed to meet the scale of the adjacent residences. The eave lines of the institutional buildings are usually very low and kept to one story or lower. The Kendall College buildings have an articulated first floor. Seabury-Western Theological Seminary is designed to a residential scale by means of gothic detailing as seen in the articulation of arches and buttresses. The institutional buildings in the district have well-developed intermediate zones in keeping with its residential character. This is evident at the Roycemore School, where the entire complex of buildings wraps around an exterior courtyard.

The district also includes structures originally built as residences, but which now house institutional uses. Such structures are included in the District because the criteria for review relate to the architecture, the built structures, and the surrounding spaces, not the particular use of a building at any given time. Therefore, a structure currently used as an institutional office is considered a residential house for the purposes of architectural review. Current office use does not change the architecture of the building but contributes to the residential character of the district.

Three Components of the District

Three components to the residential character of the district include the private homes, the streets and alleys, and the spaces between the houses and streets. All three of

these are of a consistent high quality throughout the district and contribute significantly to the integrity of the district as a whole. Viewing the houses in isolation from one another does not fully consider the architectural significance of this district. The houses in the district are of a consistent high quality, as seen in their materials, workmanship and design. They are of a consistent scale and are placed relative to one another on individual lots in a way that creates a consistent streetscape in some cases, and in other cases, creates vistas to Lake Michigan. Porches, verandas, walkways, and terraces in view of the public exist in privately owned areas. The development of this intermediate area allows the individual buildings to be viewed within a landscaped setting. The variety of architectural expressions within these elements and the landscaped setting between, taken as a whole, is irreplaceable.

The pattern of main house and outbuilding

The map included in the Nomination shows this pattern. Although there are some houses in the district with attached garages, the primary pattern illustrates that a secondary structure at a rear alley typically exists. In most cases, this secondary structure serves as automobile storage.

BOUNDARIES; CONTRIBUTING BUILDINGS

Upon consideration of these and other issues outlined in the Ordinance, and upon a complete review of the evidence presented in the Nomination and in the public hearings, the Commission recommends approval of the list of contributing structures included in Nomination with the exception that buildings dating from 1950 to the present date be classified as non-contributing; buildings dating from 1949 and earlier shall be classified as contributing or non-contributing as they are listed in the Nomination; and

even with the modification of post-1949 contributing structures to non-contributing structures, the boundaries of the proposed district shall be established as proposed in the Nomination.

The reasons for the revision are as follows: First, a change in architectural expression occurs in the district in buildings built in 1950 and later. Post-1950 houses tend spread more horizontally when compared to pre-1950 structures. They tend to have less wall surface and greater roof areas. The window areas in post-1950 houses tend to be greater than pre-1950 houses and porches tend to be minimized. In post-1950 houses the placement of windows is not often axial and there is a tendency for the houses to be of a light color. Second, the integrity of the district was already established by 1950. This includes the integrity of location as well as exceptional workmanship, design, and materials.

Pre-1950 buildings are distributed evenly throughout the district in a manner that supports the proposed boundaries. The boundaries were determined by examining where physical barriers, institutional uses, changes in land use and building age occur. The boundaries were supported by the Nomination and in the testimony heard at the hearing.

The classification of post-1950 buildings as non-contributing structures does not affect the boundaries as proposed because many of the post-1950 buildings built within the District are infill buildings constructed within otherwise completed streets. The District is comprised of streets and exterior spaces between buildings that remain unaffected by the inclusion of intermittent contemporary designs. Examples of contemporary structures that are non-contributing but allow the qualities of the district to be seen around them are the houses at the east end of Clinton Place. These houses do not

interfere with the vista that is formed toward the lake.

PROPOSED GUIDELINES

The current standards for review set forth in the Ordinance should be used in reference to the buildings in the district. The current standards are sufficiently flexible to allow the Commission the latitude to address the characteristics of the district effectively when they arise in the future.

CONCLUSION

The Commission has determined that the Northeast Evanston Historic District is truly important to the City of Evanston, its people, its culture and its history. The district meets the criteria for designation as set forth in the Ordinance. Therefore, the Commission confidently submits this recommendation to the Mayor and City Council that the Northeast Evanston Historic District be designated as an Evanston Historic District.

Respectfully submitted,

Evanston Preservation Commission

J. Kirk Irwin, Chairman

Date: 3-06-00

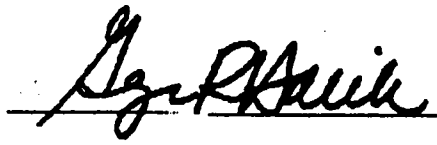
George Malik, Secretary

Date: 03-06-00

City of Evanston Northeast Evanston Historic District Boundaries - Parcels

 Historic District Boundary
Parcels

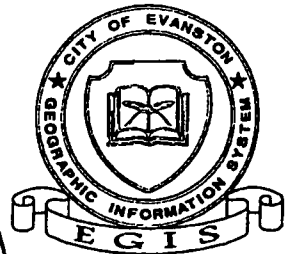
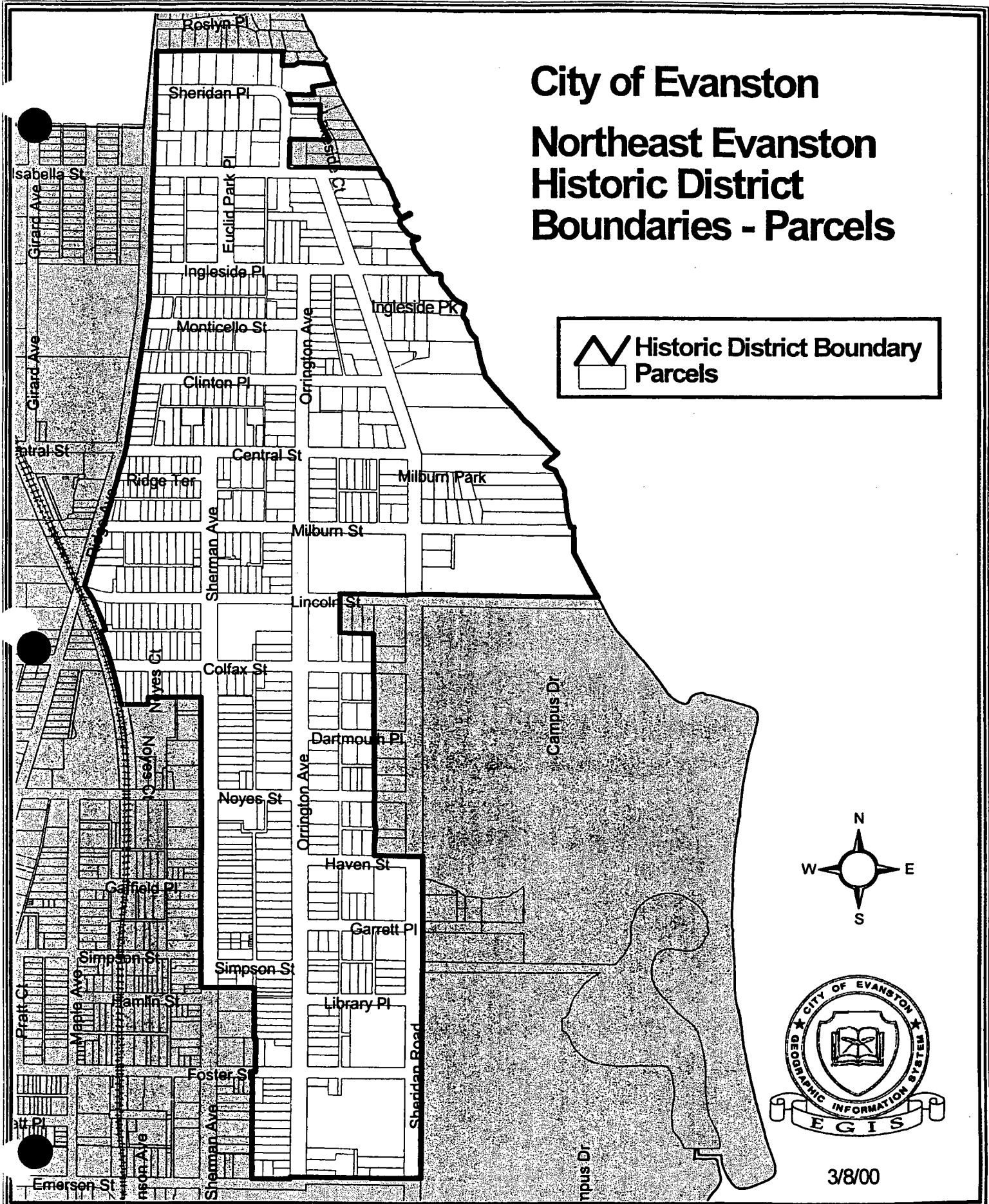

3/8/00

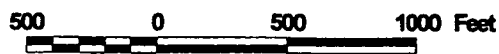

APPENDIX B
CONTRIBUTING AND NON-CONTRIBUTING STRUCTURES

Number	Street	Building Type	Date	Status
		Single Family/ Other		Contributing/ Non-Contributing
615	Central Street	S.F.	1955	NC
616	Central Street	S.F.	1909	C
616	Central Street	Garage	1924	C
621	Central Street	S.F.	1956	NC
624	Central Street	S.F.	1909	C
624	Central Street	Garage	1913	C
628	Central Street	S.F.	1911	C
628	Central Street	Garage	1988	NC
630	Central Street	S.F.	1909	C
630	Central Street	Garage	1995	NC
639	Central Street	S.F.	1919	C
639	Central Street	Pool House	1971	NC
711	Central Street	S.F.	1922	C
711	Central Street	Garage	1922	C
714	Central Street	S.F.	1923	C
714	Central Street	Garage	1941	C
717	Central Street	S.F.	1925	C
717	Central Street	Garage	1925	C
719	Central Street	S.F.	1927	C
720	Central Street	S.F.	1924	C
720	Central Street	Garage	1924	C
721	Central Street	S.F.	1921	C
721	Central Street	Garage	1921	C
724	Central Street	S.F.	1921	C
724	Central Street	Garage	unk	C
725	Central Street	S.F.	1924	C
725	Central Street	Garage	1992	NC
728	Central Street	S.F.	1957	NC
729	Central Street	S.F.	1924	C
729	Central Street	Garage	1924	C
730	Central Street	S.F.	1929	C
730	Central Street	Garage	1929	C
735	Central Street	S.F.	1923	C
736	Central Street	S.F.	1929	C
736	Central Street	Garage	unk	NC
739	Central Street	S.F.	1875	C
739	Central Street	Garage	1985	NC
745	Central Street	S.F.	1924	C
745	Central Street	Garage	1937	C
801	Central Street	S.F.	1957	NC
805	Central Street	S.F.	1957	NC
807	Central Street	S.F.	1957	NC
811	Central Street	S.F.	1921	C

Number	Street	Building Type		Date	Status	
		Single Family/ Other			Contributing/ Non-Contributing	
811	Central Street	Garage		unk	NC	
815	Central Street	S.F.		1961	NC	
817	Central Street	S.F.		1923	C	
817	Central Street	Garage		1923	C	
609	Clinton Place	S.F.		1954	NC	
610	Clinton Place	S.F.		1954	NC	
615	Clinton Place	S.F.		1955	NC	
615	Clinton Place	Garage		unk	NC	
616	Clinton Place	S.F.		1955	NC	
625	Clinton Place	S.F.		1923	C	
627	Clinton Place	S.F.		1937	C	
630	Clinton Place	S.F.		1927	C	
630	Clinton Place	Garage		unk	NC	
716	Clinton Place	S.F.		1915	C	
716	Clinton Place	Garage		1930	C	
722	Clinton Place	S.F.		1913	C	
722	Clinton Place	Garage		1929	C	
724	Clinton Place	S.F.		1925	C	
726	Clinton Place	S.F.		1898	C	
727	Clinton Place	S.F.		1912	C	
727	Clinton Place	Garage		1925	C	
731	Clinton Place	S.F.		1912	C	
731	Clinton Place	Garage		1959	NC	
734	Clinton Place	S.F.		1923	C	
734	Clinton Place	Garage		1923	C	
735	Clinton Place	S.F.		1922	C	
735	Clinton Place	Garage		1983	NC	
736	Clinton Place	S.F.		1924	C	
736	Clinton Place	Garage		1924	C	
737	Clinton Place	S.F.		1919	C	
737	Clinton Place	Garage		1921	C	
802	Clinton Place	S.F.		1915	C	
802	Clinton Place	Garage		1921	C	
803	Clinton Place	S.F.		1919	C	
803	Clinton Place	Garage		1921	C	
805	Clinton Place	S.F.		1921	C	
805	Clinton Place	Garage		1921	C	
806	Clinton Place	S.F.		1920	C	
806	Clinton Place	Garage		1923	C	
810	Clinton Place	S.F.		1921	C	
810	Clinton Place	Garage		unk	C	
811	Clinton Place	S.F.		1920	C	
811	Clinton Place	Garage		1921	C	
814	Clinton Place	S.F.		1915	C	
814	Clinton Place	Garage		1936	C	
815	Clinton Place	S.F.		1920	C	
815	Clinton Place	Garage		unk	C	
818	Clinton Place	S.F.		1920	C	

Number	Street	Building Type	Date	Status
		Single Family/ Other		Contributing/ Non-Contributing
818	Clinton Place	Garage	1921	C
819	Clinton Place	S.F.	1916	C
819	Clinton Place	Garage	1945	C
822	Clinton Place	S.F.	1921	C
822	Clinton Place	Garage	unk	C
823	Clinton Place	S.F.	1920	C
823	Clinton Place	Garage	1921	C
827	Clinton Place	S.F.	1916	C
827	Clinton Place	Garage	1928	C
831	Clinton Place	S.F.	1921	C
831	Clinton Place	Garage	1994	NC
619	Colfax Street	S.F. (dorm)	1912	C
624	Colfax Street	S.F.	1915	C
625	Colfax Street	S.F. (office)	1910	C
628	Colfax Street	S.F.	1916	C
628	Colfax Street	Play House	1917	C
628	Colfax Street	Garage	unk	NC
629	Colfax Street	S.F.	1907	C
629	Colfax Street	Garage	1962	NC
714	Colfax Street	S.F.	1908	C
714	Colfax Street	Garage	mov. 1948	C
720	Colfax Street	S.F.	1917	C
720	Colfax Street	Garage	1973	NC
724	Colfax Street	S.F.	1906	C
724	Colfax Street	Garage	1925	C
725	Colfax Street	Dormitory	1963	NC
728	Colfax Street	S.F.	1907	C
728	Colfax Street	Garage	1983	NC
732	Colfax Street	S.F.	1907	C
732	Colfax Street	Garage	1998	NC
735	Colfax Street	S.F.	1935	C
802	Colfax Street	S.F.	1908	C
802	Colfax Street	Garage	1964	NC
805	Colfax Street	S.F.	1916	C
806	Colfax Street	S.F.	1908	C
806	Colfax Street	Garage	1976	NC
807	Colfax Street	S.F.	1907	C
807	Colfax Street	Garage	1940	C
810	Colfax Street	S.F.	1908	C
810	Colfax Street	Shed	1928	C
811	Colfax Street	S.F.	1907	C
811	Colfax Street	Garage	1911	C
812	Colfax Street	S.F.	1908	C
812	Colfax Street	Garage	1912	C
815	Colfax Street	S.F.	1907	C
815	Colfax Street	Garage	1931	C
818	Colfax Street	S.F.	1908	C
818	Colfax Street	Garage	1910	C

Number	Street	Building Type		Date		Status	
		Single Family/ Other				Contributing/ Non-Contributing	
819	Colfax Street	S.F.		1908		C	
819	Colfax Street	Garage		1921		C	
822	Colfax Street	S.F.		1908		C	
822	Colfax Street	Garage		1918		C	
823	Colfax Street	S.F.		1908		C	
823	Colfax Street	Barn		1908		C	
827	Colfax Street	S.F.		1911		C	
827	Colfax Street	Garage		1940		C	
828	Colfax Street	S.F.		1908		C	
828	Colfax Street	Garage		1911		C	
900	Colfax Street	S.F.		1908		C	
900	Colfax Street	Barn		1909		C	
901	Colfax Street	S.F.		1908		C	
901	Colfax Street	Garage		1990		NC	
904	Colfax Street	S.F.		1908		C	
904	Colfax Street	Barn		1909		C	
905	Colfax Street	S.F.		1910		C	
905	Colfax Street	Garage		1919		C	
909	Colfax Street	S.F.		1909		C	
909	Colfax Street	Garage		1923		C	
911	Colfax Street	S.F.		1939		C	
618-24	Colfax Street	S.F.		1915		C	
618-24	Colfax Street	Garage		unk		C	
617	Dartmouth Place	S.F. (office)		1909		C	
617	Dartmouth Place	Garage		unk		C	
620	Dartmouth Place	Parking Lot				NC	
627	Dartmouth Place	S.F. (office)		1909		C	
627	Dartmouth Place	Garage		1915		C	
630	Dartmouth Place	S.F. (office)		1925		C	
619	Emerson Street	S.F. (office)		1922		C	
633	Emerson Street	Student Health Center		1960		NC	
711	Emerson Street	S.F.		1890		C	
711	Emerson Street	Garage		unk		C	
717	Emerson Street	Apt.		1964		NC	
2700	Euclid Park Place	S.F.		1937		C	
2703	Euclid Park Place	S.F.		1919		C	
2703	Euclid Park Place	Coach House		1919		C	
2707	Euclid Park Place	S.F.		1921		C	
2707	Euclid Park Place	Coach House		1921		C	
2738	Euclid Park Place	S.F.		1922		C	
2738	Euclid Park Place	Garage		1922		C	
2746	Euclid Park Place	S.F.		1922		C	
2749	Euclid Park Place	S.F.		1913		C	
2749	Euclid Park Place	Garage		1950		NC	
2755	Euclid Park Place	S.F.		1952		NC	
2755	Euclid Park Place	Garage		unk		C	
2756	Euclid Park Place	S.F.		1918		C	
2756	Euclid Park Place	Garage		unk		C	

Number	Street	Building Type	Date	Status	
				Contributing/	Non-Contributing
		Single Family/			
		Other			
2765	Euclid Park Place	S.F.	1925	C	
600	Foster Street	Offices	1999	NC	
617	Foster Street	Student Recreation Center	1973	NC	
629	Foster Street	Religious Center	1999	NC	
634	Foster Street	S.F.	1870	C	
709	Foster Street	S.F.	1880	C	
715	Foster Street	S.F.	1911	C	
714-16	Foster Street	Apt.	1901	C	
618	Garrett Place	S.F. (office)	1914	C	
618	Garrett Place	Garage	1916	C	
624	Garrett Place	S.F.	1916	C	
624	Garrett Place	Garage	1924, 1945	C	
625	Garrett Place	S.F.	1924	C	
625	Garrett Place	Garage	1940	C	
628	Garrett Place	S.F.	1912	C	
628	Garrett Place	Garage	1939	C	
629	Garrett Place	2-Flat	1916	C	
629	Garrett Place	Garage	1917, 1945	C	
632	Garrett Place	S.F.	1921	C	
632	Garrett Place	Garage	1987	NC	
638	Garrett Place	S.F.	1921	C	
601-15	Garrett Place	Student Apartments	1959	NC	
621-23	Garrett Place	Student Apartments	1961	NC	
600	Haven Street	Offices, Library, Dormitory,	1929	C	
600	Haven Street	Wheeler Hall Addition	1955	NC	
612	Haven Street	Dormitory	1955	NC	
617	Haven Street	S.F. (office)	1911	C	
625	Haven Street	S.F. (office)	1914	C	
625	Haven Street	Garage	1919	C	
629	Haven Street	S.F.	1913	C	
629	Haven Street	Garage	unk	NC	
638-40	Haven Street	Double House	1963	NC	
568	Ingleside Park	S.F.	1967	NC	
574	Ingleside Park	S.F.	1950	NC	
574	Ingleside Park	Garage	unk	NC	
574	Ingleside Park	Garage	unk	NC	
580	Ingleside Park	S.F.	1959	NC	
580	Ingleside Park	Garage	unk	NC	
581	Ingleside Park	S.F.	1962	NC	
586	Ingleside Park	S.F.	1925	C	
586	Ingleside Park	Garage	1925	C	
589	Ingleside Park	S.F.	1956	NC	
592	Ingleside Park	S.F.	1893	C	
592	Ingleside Park	Garage	unk	C	
582	Ingleside Place	S.F.	1907	C	
585	Ingleside Place	S.F.	1926	C	
587	Ingleside Place	S.F.	1998	NC	
591	Ingleside Place	S.F.	1998	NC	

Number	Street	Building Type	Date	Status
		Single Family/ Other		Contributing/ Non-Contributing
614	Ingleside Place	S.F.	1920	C
614	Ingleside Place	Garage	unk	C
621	Ingleside Place	S.F.	1926	C
701	Ingleside Place	S.F.	1960	NC
705	Ingleside Place	S.F.	1954	NC
707	Ingleside Place	S.F.	1998	NC
712	Ingleside Place	S.F.	1920	C
713	Ingleside Place	S.F.	1931	C
713	Ingleside Place	Shed	unk	C
716	Ingleside Place	S.F.	1922	C
720	Ingleside Place	S.F.	1925	C
720	Ingleside Place	Garage	1925	C
724	Ingleside Place	S.F.	1921	C
724	Ingleside Place	Garage	1921	C
730	Ingleside Place	S.F.	1931	C
730	Ingleside Place	Garage	1931	C
734	Ingleside Place	S.F.	1997	NC
734	Ingleside Place	Garage	1997	NC
802	Ingleside Place	S.F.	1915	C
802	Ingleside Place	Garage	1915	C
806	Ingleside Place	S.F.	1914	C
806	Ingleside Place	Garage	1917	C
810	Ingleside Place	S.F.	1916	C
810	Ingleside Place	Garage	unk	C
814	Ingleside Place	S.F.	1923	C
814	Ingleside Place	Garage	1923	C
818	Ingleside Place	S.F.	1919	C
818	Ingleside Place	Garage	1919	C
823	Ingleside Place	S.F.	1922	C
823	Ingleside Place	Garage	1957	NC
824	Ingleside Place	S.F.	1916	C
824	Ingleside Place	Garage	unk	C
828	Ingleside Place	S.F.	1923	C
828	Ingleside Place	Garage	1924	C
831	Ingleside Place	S.F.	1921	C
831	Ingleside Place	Garage	1921	C
832	Ingleside Place	S.F.	1921	C
832	Ingleside Place	Garage	1921	C
617	Library Place	S.F. (office)	1894	C
618	Library Place	Offices	1993	NC
619	Library Place	2-Flat	1915	C
619	Library Place	Coach House	1917	C
620	Library Place	S.F. (office)	1903	C
625	Library Place	S.F.	1921	C
625	Library Place	Garage	1966	NC
626	Library Place	S.F. (office)	1896	C
627	Library Place	S.F.	1894	C
627	Library Place	Garage	1937	C

Number	Street	Building Type	Date	Status
		Single Family/ Other		Contributing/ Non-Contributing
628	Library Place	Apt.	1971	NC
630	Library Place	S.F.	1927	C
637-43	Library Place	Apt.	1913	C
637-43	Library Place	Garage	1929	C
640	Lincoln Street	School	1915	C
711	Lincoln Street	S.F.	1929	C
715	Lincoln Street	S.F.	1914	C
715	Lincoln Street	Garage	unk	NC
723	Lincoln Street	2-Flat	1915	C
723	Lincoln Street	Garage	unk	C
727	Lincoln Street	S.F.	1915	C
727	Lincoln Street	Garage	1926	C
729	Lincoln Street	S.F.	1914	C
729	Lincoln Street	Shed	unk	C
731	Lincoln Street	S.F.	1914	C
731	Lincoln Street	Garage	1922	C
733	Lincoln Street	S.F.	1912	C
733	Lincoln Street	Garage	1912	C
800	Lincoln Street	S.F.	1937	C
803	Lincoln Street	2-Flat	1915	C
803	Lincoln Street	Garage	1979	NC
806	Lincoln Street	S.F.	1926	C
806	Lincoln Street	Garage	1926	C
807	Lincoln Street	S.F.	1920	C
807	Lincoln Street	Garage	unk	C
810	Lincoln Street	S.F.	1926	C
810	Lincoln Street	Garage	1926	C
811	Lincoln Street	S.F.	1909	C
811	Lincoln Street	Garage	unk	C
814	Lincoln Street	S.F.	1925	C
815	Lincoln Street	S.F.	1909	C
815	Lincoln Street	Coach House	unk	C
818	Lincoln Street	S.F.	1925	C
818	Lincoln Street	Garage	1994	NC
819	Lincoln Street	S.F.	1910	C
819	Lincoln Street	Garage	1967	NC
822	Lincoln Street	S.F.	1925	C
822	Lincoln Street	Garage	1953	NC
825	Lincoln Street	S.F.	1914	C
825	Lincoln Street	Garage	1991	NC
826	Lincoln Street	S.F.	1925	C
826	Lincoln Street	Garage	1958	NC
827	Lincoln Street	S.F.	1909	C
827	Lincoln Street	Garage	1921	C
830	Lincoln Street	S.F.	1925	C
833	Lincoln Street	S.F.	1914	C
833	Lincoln Street	Garage	1937	C
834	Lincoln Street	S.F.	1931	C

Number	Street	Building Type	Date	Status	
				Contributing/	Non-Contributing
		Single Family/			
		Other			
834	Lincoln Street	Garage	1931	C	
837	Lincoln Street	S.F.	bef.1915	NC	
837	Lincoln Street	Garage	unk	NC	
839	Lincoln Street	S.F.	1927	C	
840	Lincoln Street	S.F.	1931	C	
840	Lincoln Street	Garage	1931	C	
900	Lincoln Street	S.F.	1935	C	
902	Lincoln Street	S.F.	1935	C	
902	Lincoln Street	Garage	1950	NC	
905	Lincoln Street	Park		C	
555-59	Lincoln Street	Water Works	1874	C	
1	Milburn Park	S.F.	1954	NC	
2	Milburn Park	S.F.	1937	C	
4	Milburn Park	S.F.	1938	C	
5	Milburn Park	S.F.	1954	NC	
5	Milburn Park	Coach House	1954	NC	
6	Milburn Park	S.F.	1946	C	
7	Milburn Park	S.F.	1937	C	
8	Milburn Park	S.F.	1937	C	
10	Milburn Park	S.F.	1939	C	
11	Milburn Park	S.F.	1939	C	
12	Milburn Park	S.F.	1937	C	
611	Milburn Street	S.F.	1954	NC	
617	Milburn Street	S.F.	1909	C	
617	Milburn Street	Garage	unk	NC	
623	Milburn Street	S.F.	1909	C	
623	Milburn Street	Garage	1912	C	
625	Milburn Street	S.F.	1908	C	
625	Milburn Street	Garage	1961	NC	
625	Milburn Street	Garage	unk	C	
631	Milburn Street	S.F.	1909	C	
631	Milburn Street	Garage	1923	C	
635	Milburn Street	S.F.	1909	C	
635	Milburn Street	Garage	unk	NC	
705	Milburn Street	S.F.	1924	C	
708	Milburn Street	S.F.	1926	C	
708	Milburn Street	Play House	1969	NC	
714	Milburn Street	S.F.	1909	C	
714	Milburn Street	Garage	1934	C	
715	Milburn Street	S.F.	1924	C	
715	Milburn Street	Garage	1924	C	
719	Milburn Street	S.F.	1923	C	
719	Milburn Street	Garage	unk	C	
720	Milburn Street	S.F.	1909	C	
720	Milburn Street	Garage	1923	C	
725	Milburn Street	S.F.	1921	C	
725	Milburn Street	Garage	unk	NC	
726	Milburn Street	S.F.	1911	C	

Number	Street	Building Type		Date	Status	
		Single Family/ Other			Contributing/ Non-Contributing	
726	Milburn Street	Garage		1917	C	
729	Milburn Street	S.F.		1923	C	
729	Milburn Street	Garage		1956	NC	
730	Milburn Street	S.F.		1907	C	
730	Milburn Street	Garage		1928	C	
733	Milburn Street	S.F.		1930	C	
734	Milburn Street	S.F.		1911	C	
734	Milburn Street	Garage		1917	C	
739	Milburn Street	S.F.		1930	C	
803	Milburn Street	S.F.		1910	C	
803	Milburn Street	Garage		unk	C	
806	Milburn Street	S.F.		1910	C	
806	Milburn Street	Garage		1927	C	
807	Milburn Street	S.F.		1922	C	
807	Milburn Street	Garage		1934	C	
810	Milburn Street	S.F.		1910	C	
810	Milburn Street	Garage		1916	C	
811	Milburn Street	S.F.		1924	C	
811	Milburn Street	Garage		1924	C	
815	Milburn Street	S.F.		1917	C	
816	Milburn Street	S.F.		1911	C	
816	Milburn Street	Garage		1916	C	
819	Milburn Street	S.F.		1926	C	
820	Milburn Street	S.F.		1910	C	
820	Milburn Street	Garage		1962	NC	
821	Milburn Street	S.F.		1922	C	
821	Milburn Street	Garage		1937	C	
822	Milburn Street	S.F.		1913	C	
822	Milburn Street	Garage		1915	C	
824	Milburn Street	S.F.		1910	C	
824	Milburn Street	Garage		1915	C	
825	Milburn Street	S.F.		1921	C	
825	Milburn Street	Garage		1921	C	
826	Milburn Street	S.F.		1915	C	
826	Milburn Street	Garage		1923	C	
830	Milburn Street	S.F.		1910	C	
830	Milburn Street	Barn		1910	C	
831	Milburn Street	S.F.		1860	C	
831	Milburn Street	Garage		1927	C	
835	Milburn Street	S.F.		1922	C	
835	Milburn Street	Garage		1925	C	
836	Milburn Street	S.F.		1958	NC	
839	Milburn Street	S.F.		1922	C	
839	Milburn Street	Garage		1975	NC	
840	Milburn Street	S.F.		1958	NC	
715	Monticello Place	S.F.		1914	C	
715	Monticello Place	Garage		1924	C	
719	Monticello Place	S.F.		1924	C	

Number	Street	Building Type	Date	Status
		Single Family/ Other		Contributing/ Non-Contributing
719	Monticello Place	Garage	1924	C
723	Monticello Place	S.F.	1923	C
723	Monticello Place	Garage	1923	C
727	Monticello Place	S.F.	1927	C
731	Monticello Place	S.F.	1915	C
731	Monticello Place	Garage	1993	NC
734	Monticello Place	S.F.	1920	C
735	Monticello Place	S.F.	1915	C
735	Monticello Place	Garage	1991	NC
800	Monticello Place	S.F.	1923	C
800	Monticello Place	Garage	unk	NC
803	Monticello Place	S.F.	1914	C
806	Monticello Place	S.F.	1922	C
806	Monticello Place	Garage	1927	C
807	Monticello Place	S.F.	1915	C
807	Monticello Place	Garage	1947	C
809	Monticello Place	S.F.	1916	C
809	Monticello Place	Garage	1917	C
810	Monticello Place	S.F.	1914	C
810	Monticello Place	Garage	1914	C
811	Monticello Place	S.F.	1915	C
811	Monticello Place	Garage	1915	C
812	Monticello Place	S.F.	1919	C
812	Monticello Place	Garage	1920	C
816	Monticello Place	S.F.	1920	C
817	Monticello Place	S.F.	1950	NC
817	Monticello Place	Garage	1950	NC
817	Monticello Place	Pavilion	unk	NC
822	Monticello Place	S.F.	1915	C
822	Monticello Place	Garage	1927	C
823	Monticello Place	S.F.	1916	C
823	Monticello Place	Garage	1983	NC
824	Monticello Place	S.F.	1916	C
824	Monticello Place	Garage	1972	NC
827	Monticello Place	S.F.	1952	NC
830	Monticello Place	S.F.	1922	C
616	Noyes Street	S.F. (office)	1900	C
617	Noyes Street	S.F. (office)	1912	C
617	Noyes Street	Garage	1927	C
624	Noyes Street	S.F.	1902	C
624	Noyes Street	Garage	1945	C
625	Noyes Street	S.F. (office)	1898	C
629	Noyes Street	S.F. (office)	1912	C
719	Noyes Street	S.F.	1898	C
719	Noyes Street	Garage	1911	C
725	Noyes Street	S.F.	1898	C
725	Noyes Street	Garage	1926	C
718-34	Noyes Street	Co-op Apt.	1927	C

Number	Street	Building Type	Date	Status	
		Single Family/ Other		Contributing/ Non-Contributing	
1900	Orrington Avenue	Apt.	1914	C	
1906	Orrington Avenue	S.F.	1875	C	
1906	Orrington Avenue	Garage	1967	NC	
1910	Orrington Avenue	S.F.	1906	C	
1910	Orrington Avenue	Garage	unk	C	
1914	Orrington Avenue	S.F.	1895	C	
1914	Orrington Avenue	Garage	1925	C	
1915	Orrington Avenue	2-Flat	1916	C	
1918	Orrington Avenue	S.F.	1890	C	
1918	Orrington Avenue	Garage	1916	C	
1922	Orrington Avenue	S.F.	1896	C	
1922	Orrington Avenue	Barn	unk	C	
1926	Orrington Avenue	S.F.	1890	C	
1926	Orrington Avenue	Garage	unk	NC	
1927	Orrington Avenue	Dormitory	1970	NC	
1930	Orrington Avenue	S.F.	1890	C	
1930	Orrington Avenue	Garage	1921	C	
1934	Orrington Avenue	S.F.	1890	C	
1934	Orrington Avenue	Garage	1924	C	
1936	Orrington Avenue	S.F.	1894	C	
1936	Orrington Avenue	Garage	1924	C	
1940	Orrington Avenue	S.F.	1895	C	
1940	Orrington Avenue	Garage	1925	C	
1941	Orrington Avenue	S.F.	1941	C	
1942	Orrington Avenue	S.F.	1895	C	
1942	Orrington Avenue	Garage	1925	C	
1945	Orrington Avenue	S.F.	1955	NC	
1946	Orrington Avenue	S.F.	1895	C	
1946	Orrington Avenue	Garage	unk	NC	
2001	Orrington Avenue	Double House	1892	C	
2005	Orrington Avenue	S.F.	1894	C	
2005	Orrington Avenue	Garage	unk	NC	
2010	Orrington Avenue	S.F.	1890	C	
2010	Orrington Avenue	Garage	1936	C	
2011	Orrington Avenue	S.F.	1922	C	
2011	Orrington Avenue	Garage	1922	C	
2014	Orrington Avenue	2-Flat	1903,1960s	NC	
2015	Orrington Avenue	S.F.	1910	C	
2015	Orrington Avenue	Coach House	1910	C	
2018	Orrington Avenue	S.F.	1890	C	
2018	Orrington Avenue	Garage	1920	C	
2019	Orrington Avenue	S.F.	1905	C	
2019	Orrington Avenue	Garage	unk	C	
2020	Orrington Avenue	S.F.	1885	C	
2020	Orrington Avenue	Garage	unk	NC	
2023	Orrington Avenue	S.F.	1978	NC	
2023	Orrington Avenue	Garage	1978	NC	
2024	Orrington Avenue	S.F.	1880	C	

Number	Street	Building Type	Date	Status
		Single Family/ Other		Contributing/ Non-Contributing
2026	Orrington Avenue	S.F.	1903	C
2026	Orrington Avenue	Garage	unk	C
2027	Orrington Avenue	S.F.	1875	C
2027	Orrington Avenue	Garage	1997	NC
2030	Orrington Avenue	S.F.	1903	C
2030	Orrington Avenue	Garage	unk	C
2032	Orrington Avenue	Garage	unk	NC
2034	Orrington Avenue	Garage	unk	NC
2036	Orrington Avenue	S.F.	1905	C
2036	Orrington Avenue	Garage	unk	C
2036	Orrington Avenue	Garage	unk	NC
2039	Orrington Avenue	S.F.	1900	C
2039	Orrington Avenue	Garage	1922	C
2040	Orrington Avenue	S.F.	1905	C
2040	Orrington Avenue	Garage	unk	C
2043	Orrington Avenue	S.F.	1928	C
2043	Orrington Avenue	Garage	1928	C
2047	Orrington Avenue	S.F.	1928	C
2047	Orrington Avenue	Garage	1928	C
2102	Orrington Avenue	S.F.	1890	C
2102	Orrington Avenue	Garage	unk	C
2103	Orrington Avenue	S.F.	1895	C
2103	Orrington Avenue	Garage	1924	C
2106	Orrington Avenue	S.F.	1895	C
2106	Orrington Avenue	Garage	1924	C
2110	Orrington Avenue	S.F.	1898	C
2110	Orrington Avenue	Garage	1985	NC
2111	Orrington Avenue	S.F.	1921	NC
2112	Orrington Avenue	S.F.	1893	C
2112	Orrington Avenue	Garage	1990	NC
2112	Orrington Avenue	Garage	unk	C
2118	Orrington Avenue	S.F.	1899	C
2118	Orrington Avenue	Garage	1918	C
2118	Orrington Avenue	Garage	unk	NC
2121	Orrington Avenue	S.F.	1909	C
2121	Orrington Avenue	Garage	1922	C
2122	Orrington Avenue	S.F.	1909	C
2122	Orrington Avenue	Garage	1922	C
2126	Orrington Avenue	S.F.	1890	C
2126	Orrington Avenue	Garage	1953	NC
2127	Orrington Avenue	S.F.	1903	C
2127	Orrington Avenue	Garage	1966	NC
2130	Orrington Avenue	S.F.	1915	C
2130	Orrington Avenue	Garage	unk	NC
2131	Orrington Avenue	S.F.	1965	NC
2131	Orrington Avenue	Garage	1966	NC
2134	Orrington Avenue	S.F.	1911	C
2134	Orrington Avenue	Garage	1972	NC

Number	Street	Building Type		Date	Status	
		Single Family/ Other			Contributing/ Non-Contributing	
2135	Orrington Avenue	S.F.		1902	C	
2135	Orrington Avenue	Garage		1913	C	
2138	Orrington Avenue	Garage		1920	C	
2138	Orrington Avenue	S.F.		1921	C	
2145	Orrington Avenue	Double House		1963	NC	
2146	Orrington Avenue	S.F.		1912	C	
2146	Orrington Avenue	Garage		1920	C	
2203	Orrington Avenue	S.F.		1895	C	
2203	Orrington Avenue	Garage		1979	NC	
2204	Orrington Avenue	S.F.		1899	C	
2204	Orrington Avenue	Garage		1904	C	
2206	Orrington Avenue	S.F.		1912	C	
2206	Orrington Avenue	Coach House		1917	C	
2207	Orrington Avenue	S.F.		1900	C	
2207	Orrington Avenue	Garage		1985	NC	
2214	Orrington Avenue	S.F.		1919	C	
2215	Orrington Avenue	S.F.		1900	C	
2215	Orrington Avenue	Garage		1969	NC	
2218	Orrington Avenue	S.F.		1919	C	
2219	Orrington Avenue	S.F.		1923	C	
2219	Orrington Avenue	Garage		1936	C	
2222	Orrington Avenue	S.F.		1921	C	
2233	Orrington Avenue	S.F.		1909	C	
2233	Orrington Avenue	Garage		1937	C	
2236	Orrington Avenue	S.F.		1895	C	
2236	Orrington Avenue	Coach House		1906	C	
2243	Orrington Avenue	S.F.		1892	C	
2243	Orrington Avenue	Garage		1967	NC	
2244	Orrington Avenue	S.F.		1906	C	
2244	Orrington Avenue	Garage		1917	C	
2246	Orrington Avenue	S.F.		1915	C	
2246	Orrington Avenue	Garage		1917	C	
2247	Orrington Avenue	Garage		1922	C	
2247	Orrington Avenue	S.F.		1923	C	
2252	Orrington Avenue	S.F.		1914	C	
2252	Orrington Avenue	Coach House		1917	C	
2255	Orrington Avenue	S.F.		1913	C	
2255	Orrington Avenue	Garage		unk	C	
2302	Orrington Avenue	S.F.		1925	C	
2302	Orrington Avenue	Garage		1927	C	
2306	Orrington Avenue	S.F.		1875	C	
2306	Orrington Avenue	Coach House		1926	C	
2306	Orrington Avenue	Garage		1993	NC	
2307	Orrington Avenue	S.F.		1916	C	
2307	Orrington Avenue	Coach House		1917	C	
2314	Orrington Avenue	S.F.		1927	C	
2315	Orrington Avenue	S.F.		1922	C	
2315	Orrington Avenue	Garage		1924	C	

Number	Street	Building Type	Date	Status
		Single Family/ Other		Contributing/ Non-Contributing
2316	Orrington Avenue	S.F.	1905	C
2316	Orrington Avenue	Garage	1912	C
2316	Orrington Avenue	Garage	unk	NC
2320	Orrington Avenue	S.F.	1905	C
2320	Orrington Avenue	Garage	1998	NC
2323	Orrington Avenue	S.F.	1921	C
2323	Orrington Avenue	Garage	unk	C
2326	Orrington Avenue	S.F.	1908	C
2326	Orrington Avenue	Garage	unk	NC
2330	Orrington Avenue	S.F.	1908	C
2330	Orrington Avenue	Garage	1921	C
2331	Orrington Avenue	S.F.	1919	C
2340	Orrington Avenue	S.F.	1905	C
2344	Orrington Avenue	S.F.	1908	C
2344	Orrington Avenue	Garage	1919	C
2408	Orrington Avenue	School	1907	C
2420	Orrington Avenue	S.F.	1929	C
2424	Orrington Avenue	S.F.	1929	C
2430	Orrington Avenue	S.F.	1927	C
2430	Orrington Avenue	Garage	unk	C
2436	Orrington Avenue	S.F.	1909	C
2436	Orrington Avenue	Garage	unk	C
2440	Orrington Avenue	S.F.	1909	C
2440	Orrington Avenue	Garage	unk	C
2505	Orrington Avenue	S.F.	1909	C
2510	Orrington Avenue	S.F.	1925	C
2511	Orrington Avenue	S.F.	1925	C
2511	Orrington Avenue	Garage	unk	C
2515	Orrington Avenue	S.F.	1908	C
2515	Orrington Avenue	Garage	unk	C
2518	Orrington Avenue	S.F.	1922	C
2518	Orrington Avenue	Garage	unk	C
2519	Orrington Avenue	S.F.	1914	C
2519	Orrington Avenue	Garage	unk	C
2522	Orrington Avenue	S.F.	1923	C
2525	Orrington Avenue	S.F.	1924	C
2525	Orrington Avenue	Garage	unk	C
2529	Orrington Avenue	S.F.	1921	C
2529	Orrington Avenue	Garage	unk	C
2600	Orrington Avenue	S.F.	1922	C
2608	Orrington Avenue	S.F.	1900	C
2614	Orrington Avenue	S.F.	1925	C
2614	Orrington Avenue	Garage	unk	C
2618	Orrington Avenue	S.F.	1925	C
2618	Orrington Avenue	Garage	unk	C
2622	Orrington Avenue	S.F.	1923	C
2622	Orrington Avenue	Garage	unk	NC
2626	Orrington Avenue	S.F.	1921	C

Number	Street	Building Type	Date	Status
		Single Family/ Other		Contributing/ Non-Contributing
2626	Orrington Avenue	Garage	unk	NC
2636	Orrington Avenue	School	1911	C
2637	Orrington Avenue	S.F.	1924	C
2643	Orrington Avenue	S.F.	1924	C
2645	Orrington Avenue	S.F.	1923	C
2645	Orrington Avenue	Garage	unk	C
2649	Orrington Avenue	S.F.	1923	C
2649	Orrington Avenue	Garage	unk	C
2653	Orrington Avenue	S.F.	1923	C
2653	Orrington Avenue	Garage	unk	NC
2657	Orrington Avenue	S.F.	1920	C
2657	Orrington Avenue	Garage	unk	C
2661	Orrington Avenue	S.F.	1910	C
2662	Orrington Avenue	S.F.	1916	C
2665	Orrington Avenue	S.F.	1910	C
2665	Orrington Avenue	Garage	unk	C
2668	Orrington Avenue	S.F.	1924	C
2669	Orrington Avenue	S.F.	1923	C
2672	Orrington Avenue	S.F.	1921	C
2672	Orrington Avenue	Garage	unk	C
2673	Orrington Avenue	S.F.	1916	C
2676	Orrington Avenue	S.F.	1920	C
2677	Orrington Avenue	S.F.	1922	C
2677	Orrington Avenue	Garage	unk	C
2680	Orrington Avenue	S.F.	1920	C
2001-03	Orrington Avenue	Garage	1925	C
2032-34	Orrington Avenue	Double House	1894	C
2437	Ridge Avenue	S.F.	1922	C
2437	Ridge Avenue	Garage	1992	NC
2441	Ridge Avenue	Garage	1945	C
2441	Ridge Avenue	S.F.	1946	C
2505	Ridge Avenue	S.F.	1921	C
2505	Ridge Avenue	Garage	unk	C
2505	Ridge Avenue	Shed	unk	NC
2519	Ridge Avenue	S.F.	1922	C
2519	Ridge Avenue	Garage	unk	C
2535	Ridge Avenue	S.F.	1940	C
2601	Ridge Avenue	S.F.	1875	C
2601	Ridge Avenue	Garage	1971	NC
2607	Ridge Avenue	S.F.	1910	C
2607	Ridge Avenue	Garage	1988	NC
2609	Ridge Avenue	S.F.	1900	C
2609	Ridge Avenue	Garage	1954	NC
2615	Ridge Avenue	S.F.	1921	C
2619	Ridge Avenue	S.F.	1880	C
2619	Ridge Avenue	Garage	1928	C
2623	Ridge Avenue	S.F.	1914	C
2623	Ridge Avenue	Garage	1940	C

Number	Street	Building Type		Date	Status	
		Single Family/ Other			Contributing/ Non-Contributing	
2629	Ridge Avenue	S.F.		1913	C	
2629	Ridge Avenue	Garage		1927	C	
2637	Ridge Avenue	S.F.		1931	C	
2705	Ridge Avenue	S.F.		1913	C	
2705	Ridge Avenue	Garage		1971	NC	
2733	Ridge Avenue	S.F.		1921	C	
2739	Ridge Avenue	S.F.		1926	C	
2739	Ridge Avenue	Garage		1945	C	
2743	Ridge Avenue	S.F.		1924	C	
2743	Ridge Avenue	Garage		1990	NC	
2747	Ridge Avenue	S.F.		1921	C	
2747	Ridge Avenue	Garage		1949	C	
2751	Ridge Avenue	S.F.		1921	C	
2751	Ridge Avenue	Garage		1982	NC	
2757	Ridge Avenue	S.F.		1921	C	
2757	Ridge Avenue	Garage		1994	NC	
2759	Ridge Avenue	S.F.		1860	C	
800	Ridge Terrace	S.F.		1923	C	
800	Ridge Terrace	Garage		unk	C	
801	Ridge Terrace	S.F.		1925	C	
802	Ridge Terrace	S.F.		1923	C	
802	Ridge Terrace	Garage		1923	C	
805	Ridge Terrace	S.F.		1924	C	
806	Ridge Terrace	S.F.		1922	C	
806	Ridge Terrace	Garage		1923	C	
809	Ridge Terrace	S.F.		1924	C	
810	Ridge Terrace	S.F.		1927	C	
810	Ridge Terrace	Garage		unk	C	
811	Ridge Terrace	S.F.		1924	C	
811	Ridge Terrace	Garage		1924	C	
814	Ridge Terrace	S.F.		1921	NC	
814	Ridge Terrace	Garage		1926	C	
815	Ridge Terrace	S.F.		1915	C	
815	Ridge Terrace	Garage		1988	NC	
816	Ridge Terrace	S.F.		1922	C	
820	Ridge Terrace	S.F.		1921	C	
820	Ridge Terrace	Garage		1921	C	
823	Ridge Terrace	S.F.		1915	C	
823	Ridge Terrace	Garage		1923	C	
824	Ridge Terrace	S.F.		1916	C	
824	Ridge Terrace	Garage		1919	C	
825	Ridge Terrace	S.F.		1921	C	
825	Ridge Terrace	Garage		1921	C	
829	Ridge Terrace	S.F.		1915	C	
829	Ridge Terrace	Garage		1916	C	
830	Ridge Terrace	S.F.		1921	C	
830	Ridge Terrace	Garage		1925	C	
832	Ridge Terrace	S.F.		1922	C	

Number	Street	Building Type	Date	Status
		Single Family/ Other		Contributing/ Non-Contributing
832	Ridge Terrace	Garage	unk	NC
833	Ridge Terrace	S.F.	1939	C
833	Ridge Terrace	Garage	1939	C
2810	Sheridan Place	S.F.	1960	NC
2829	Sheridan Place	S.F.	1911	C
2831	Sheridan Place	S.F.	1911	C
2837	Sheridan Place	S.F.	1929	C
2837	Sheridan Place	Coach House	1929	C
2841	Sheridan Place	S.F.	1958	NC
2845	Sheridan Place	S.F.	1910	C
2845	Sheridan Place	Garage	1945	C
2848	Sheridan Place	S.F.	1923	C
2848	Sheridan Place	Garage	1923	C
2855	Sheridan Place	S.F.	1911	C
2855	Sheridan Place	Garage	1927	C
2856	Sheridan Place	S.F.	1927	C
2856	Sheridan Place	Garage	1927	C
2864	Sheridan Place	S.F.	1919	C
2864	Sheridan Place	Garage	unk	C
2865	Sheridan Place	S.F.	1912	C
2865	Sheridan Place	Coach House	1915	C
2870	Sheridan Place	S.F.	1926	C
2877	Sheridan Place	S.F.	1967	NC
2878	Sheridan Place	S.F.	1915	C
2878	Sheridan Place	Garage	1933	C
2881	Sheridan Place	S.F.	1923	C
2888	Sheridan Place	S.F.	1926	C
2895	Sheridan Place	S.F.	1951	NC
2896	Sheridan Place	S.F.	1954	NC
2800-08	Sheridan Place	S.F.	1914	C
2800-08	Sheridan Place	Coach House	unk	C
1902	Sheridan Road	S.F. (office)	1901	C
1908	Sheridan Road	S.F. (office)	1892	C
1914	Sheridan Road	S.F. (office)	1884	C
1918	Sheridan Road	S.F. (office)	1922	C
1922	Sheridan Road	S.F. (office)	1911	C
1936	Sheridan Road	S.F. (office)	1893	C
1940	Sheridan Road	S.F. (office)	1894	C
2000	Sheridan Road	S.F. (office)	1921	C
2006	Sheridan Road	S.F. (office)		C
2010	Sheridan Road	S.F. (office)	1917	C
2016	Sheridan Road	S.F. (office)	1893	C
2036	Sheridan Road	Vacant Land		C
2040	Sheridan Road	S.F. (office)	1905	C
2040	Sheridan Road	Garage		C
2044	Sheridan Road	S.F.	1901	C
2044	Sheridan Road	Garage		C
2046	Sheridan Road	S.F. (office)	1910	C

Number	Street	Building Type	Date	Status	
				Contributing/	Non-Contributing
		Single Family/			
		Other			
2110	Sheridan Road	Religious Center	1967	NC	
2436	Sheridan Road	Long Field		C	
2437	Sheridan Road	S.F.	1916	C	
2437	Sheridan Road	Garage	1985	NC	
2441	Sheridan Road	Vacant Land		C	
2500	Sheridan Road	S.F.	1959	NC	
2510	Sheridan Road	S.F.	1963	NC	
2514	Sheridan Road	S.F.	1909	C	
2514	Sheridan Road	Garage	1920	C	
2520	Sheridan Road	S.F.	1911	C	
2520	Sheridan Road	Garage	1927	C	
2528	Sheridan Road	S.F.	1911	C	
2528	Sheridan Road	Garage	1916	C	
2535	Sheridan Road	Light House	1873-74	C	
2535	Sheridan Road	Fog House	1873-74	C	
2535	Sheridan Road	Fog House	1873-74	C	
2603	Sheridan Road	S.F. (Art Center)	1927	C	
2603	Sheridan Road	Coach House	1927	C	
2603	Sheridan Road	Rest Rooms	1978	NC	
2604	Sheridan Road	S.F.	1955	NC	
2615	Sheridan Road	Picnic Shelter	1978	NC	
2618	Sheridan Road	S.F.	1954	NC	
2626	Sheridan Road	S.F.	1954	NC	
2645	Sheridan Road	Park		C	
2651	Sheridan Road	S.F.	1956	NC	
2651	Sheridan Road	Play House	unk	NC	
2652	Sheridan Road	S.F.	1954	NC	
2652	Sheridan Road	Garage	unk	NC	
2652	Sheridan Road	Pool House	unk	NC	
2653	Sheridan Road	S.F.	1979	NC	
2655	Sheridan Road	Coach House	1895	C	
2655	Sheridan Road	Garage	unk	NC	
2658	Sheridan Road	S.F.	1923	C	
2658	Sheridan Road	Coach House	1924	C	
2664	Sheridan Road	S.F.	1953	NC	
2668	Sheridan Road	S.F.	1953	NC	
2674	Sheridan Road	S.F.	1925	C	
2674	Sheridan Road	Garage	1978	NC	
2678	Sheridan Road	S.F.	1924	C	
2678	Sheridan Road	Garage	unk	C	
2681	Sheridan Road	Garage	1907	C	
2681	Sheridan Road	S.F.	1892-93	C	
2686	Sheridan Road	S.F.	1927	C	
2702	Sheridan Road	S.F.	1912	C	
2702	Sheridan Road	Garage	unk	C	
2714	Sheridan Road	S.F.	1926	C	
2714	Sheridan Road	Garage	1926	C	
2715	Sheridan Road	S.F.	1978	NC	

Number	Street	Building Type	Date	Status
		Single Family/ Other		Contributing/ Non-Contributing
2717	Sheridan Road	S.F.	1956	NC
2718	Sheridan Road	S.F.	1926	C
2718	Sheridan Road	Garage	1926	NC
2719	Sheridan Road	S.F.	1909	C
2726	Sheridan Road	S.F.	1912	C
2726	Sheridan Road	Coach House	1915	C
2729	Sheridan Road	S.F.	1925	C
2730	Sheridan Road	S.F.	1923	C
2734	Sheridan Road	S.F.	1922	C
2734	Sheridan Road	Garage	1922	C
2735	Sheridan Road	S.F.	1909	C
2735	Sheridan Road	Coach House	unk	C
2737	Sheridan Road	S.F.	1977	NC
2750	Sheridan Road	S.F.	1927	C
2754	Sheridan Road	S.F.	1922	C
2758	Sheridan Road	S.F.	1952	NC
2767	Sheridan Road	S.F.	1919	C
2767	Sheridan Road	Garage	1922	C
2769	Sheridan Road	S.F.	1920	C
2769	Sheridan Road	Garage	1927	C
2770	Sheridan Road	S.F.	1976	NC
2771	Sheridan Road	S.F.	1936	C
2773	Sheridan Road	S.F.	1974	NC
2775	Sheridan Road	S.F.	1954	NC
2776	Sheridan Road	S.F.	1977	NC
2780	Sheridan Road	S.F.	1928	C
2783	Sheridan Road	S.F.	1955	NC
2784	Sheridan Road	S.F.	1952	NC
2801	Sheridan Road	S.F.	1954	NC
2815	Sheridan Road	S.F.	1956	NC
2823	Sheridan Road	S.F.	1956	NC
2039	Sherman Avenue	2-Flat	1909	C
2043	Sherman Avenue	S.F.	1894	C
2107	Sherman Avenue	Town House	1972	NC
2109	Sherman Avenue	Town House	1972	NC
2111	Sherman Avenue	Town House	1972	NC
2115	Sherman Avenue	S.F.	1900	C
2115	Sherman Avenue	Garage	unk	C
2115	Sherman Avenue	Garage	unk	C
2119	Sherman Avenue	S.F.	1895	C
2119	Sherman Avenue	Garage	unk	NC
2123	Sherman Avenue	S.F.	1895	C
2123	Sherman Avenue	Garage	unk	NC
2125	Sherman Avenue	S.F.	1895	C
2125	Sherman Avenue	Garage	unk	C
2129	Sherman Avenue	S.F.	1896	C
2129	Sherman Avenue	Garage	unk	C
2131	Sherman Avenue	S.F.	1893	C

Number	Street	Building Type	Date	Status
		Single Family/ Other		Contributing/ Non-Contributing
2131	Sherman Avenue	Garage	unk	C
2135	Sherman Avenue	S.F.	1894	C
2135	Sherman Avenue	Garage	unk	NC
2137	Sherman Avenue	S.F.	1894	C
2137	Sherman Avenue	Garage	unk	C
2141	Sherman Avenue	2-Flat	1905	C
2141	Sherman Avenue	Garage	unk	NC
2145	Sherman Avenue	2-Flat	1905	C
2145	Sherman Avenue	Garage	unk	C
2147	Sherman Avenue	S.F.	1895	C
2147	Sherman Avenue	Garage	unk	C
2149	Sherman Avenue	S.F.	1895	C
2149	Sherman Avenue	Garage	unk	C
2151	Sherman Avenue	S.F.	1895	C
2151	Sherman Avenue	Garage	unk	C
2201	Sherman Avenue	S.F.	1915	C
2201	Sherman Avenue	Garage	1920	C
2205	Sherman Avenue	S.F.	1913	C
2205	Sherman Avenue	Garage	1928	C
2207	Sherman Avenue	S.F.	1901	C
2207	Sherman Avenue	Garage	1925	C
2211	Sherman Avenue	S.F.	1901	C
2211	Sherman Avenue	Garage	1995	NC
2233	Sherman Avenue	S.F.	1899	C
2233	Sherman Avenue	Garage	1997	NC
2235	Sherman Avenue	S.F.	1899	C
2237	Sherman Avenue	S.F.	1898	C
2237	Sherman Avenue	Garage	unk	C
2241	Sherman Avenue	S.F.	1905	C
2241	Sherman Avenue	Garage	unk	C
2249	Sherman Avenue	S.F.	1900	C
2249	Sherman Avenue	Garage	unk	NC
2253	Sherman Avenue	S.F.	1901	C
2253	Sherman Avenue	Garage	unk	NC
2301	Sherman Avenue	S.F.	1911	C
2301	Sherman Avenue	Garage	unk	C
2305	Sherman Avenue	S.F.	1907	C
2305	Sherman Avenue	Garage	unk	NC
2309	Sherman Avenue	S.F.	1904	C
2309	Sherman Avenue	Garage	unk	C
2311	Sherman Avenue	S.F.	1904	C
2311	Sherman Avenue	Garage	unk	NC
2315	Sherman Avenue	S.F.	1907	C
2315	Sherman Avenue	Garage	unk	NC
2319	Sherman Avenue	S.F.	1907	C
2319	Sherman Avenue	Garage	1950	NC
2346	Sherman Avenue	S.F.	1916	C
2346	Sherman Avenue	Garage	1919	C

Number	Street	Building Type	Date	Status	
		Single Family/		Contributing/	
		Other		Non-Contributing	
2351	Sherman Avenue	S.F. (office)	1941	C	
2433	Sherman Avenue	S.F.	1911	C	
2433	Sherman Avenue	Garage	1963	NC	
2434	Sherman Avenue	S.F.	1915	C	
2434	Sherman Avenue	Garage	unk	NC	
2436	Sherman Avenue	S.F.	1915	C	
2436	Sherman Avenue	Garage	unk	C	
2442	Sherman Avenue	S.F.	1923	C	
2442	Sherman Avenue	Garage	1945	C	
2515	Sherman Avenue	S.F.	1923	C	
2519	Sherman Avenue	S.F.	1923	C	
718-24	Simpson Street	Apt.	1909	C	
721-31	Simpson Street	Apt.	1916	C	
		968		968	

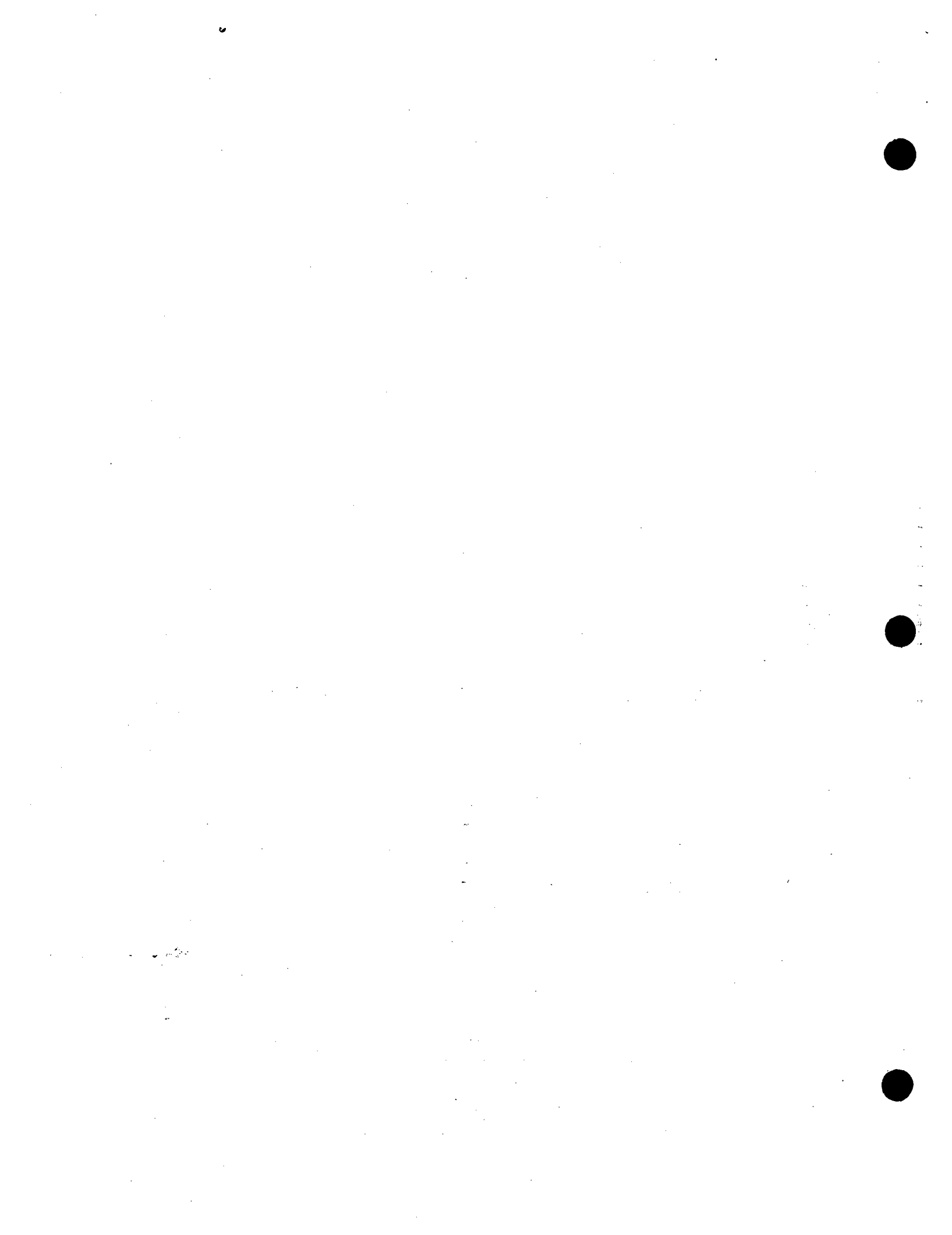

APPENDIX C
LIST OF DOCUMENTS IN THE RECORD

Document Type or Title	From	Pages (+Attachments)	Date
Letter (and attachment)	Evanstonians for Responsible Preserva	2 (+1)	9/8/99
Letter	Tom McMahan, ERP	3	9/13/99
Memo	Tom and Ann McMahan	2	9/18/99
Letter (and copy of ERP letter)	NEHDA	1 (+2)	9/19/99
Memo	Tom McMahan	1	9/20/99
Letter re McMahons and ERP	Robert Best	2	9/27/99
Letter re ERP	Robert Best	1	9/27/99
Letter re Comprehensive General Plan	Robert Best	6	10/8/99
Letter re Draft CGP	Evanstonians for Responsible Preserva	6	10/8/99
Historic District Nomination	NEHDA, NNA, STCA		10/19/99
Notice of Public Hearing	Preservation Commission	2	10/28/99
Notification to Property Owners	Preservation Commission	1(+2)	10/28/99
Certificate of Mailing	Carlos D. Ruiz (Preservation Coordinat	1+	10/29/00
Memo	Judy Fiske, NEHDA	1(+1)	11/2/99
Letter	Donald L. Schaffer	1	11/3/99
Memo to John Beischke (Evanston Revie	Carlos D. Ruiz (Preservation Coordinat	1	11/9/99
Evanston Review (Notice of Public Hearin	Preservation Commission	1	11/11/99
Informational Public Meeting	Preservation Commission	2(+1)	11/11/99
Memo	Dewey Community Conference	2	11/15/99
Memo	Jack Weiss	1	11/16/99
Testimony	Eleanor White	1	11/16/99
Hearing Sign Up Sheet (In Support)		3	11/17/99+
Hearing Sign Up Sheet (In Opposition)		4	11/17/99+
Hearing Information	Evanston Preservation Commission	2(+1)	11/17/99
Letter	Ann Diener, Pres. League of Ev.	1	11/17/99
Testimony	Polly Hawkins	3	11/17/99
Presentation to EPC	Mary McWilliams	6	11/17/99
Testimony	Patricia Money-Melvin	4	11/17/99
Testimony	Mary Brugliera	1	11/17/99
Testimony	Anne O. Earle	1	11/17/99
Memo	Edwin R. Bates	1	11/17/99
Hearing Transcript	C. Thomas	145	11/17/99
Letter	Astri L. Lindberg	1	11/22/99
Letter	Susan Solway, IHSAC	1	11/25/99
Letters (2)	Save the Cottage Assoc.	2	11/29/99
Testimony (and attachments)	Judy Fiske, NEHDA	4 (+2)	12/1/99
Testimony (and attachments)	Mark Burnette, NEHDA	2 (+3)	12/1/99
Testimony	Andrea & George Gaines	2	12/1/99
Testimony	Jane & Howard Alt	1	12/1/99
Testimony	Muffy Hendershot	2	12/1/99
Testimony	Jim McGuire	2	12/1/99
Testimony (and attachment)	Jeanne K. Lindwall	3 (+1)	12/1/99
Hearing Transcript	Denise Andras	123	12/1/99
Testimony	Barbara Mortensen	2	12/8 + 12/14/99
Memo (and slide presentation)	Robert J. Best	1 (+8)	12/2/99

Document Type or Title	From	Pages (+Attachments)	Date
Testimony	Jane S. Smith	2	12/12/99
Statement	Kay Gibbs-Novy & Stuart Novy	1	12/14/99
Testimony	Daniel Wefler	3	12/14/99
Testimony	Marjorie & Charles Benton	1	12/14/99
Hearing Transcript	Denise Andras	126	12/14/99
Testimony	John Saliba	1	12/14/99
Letter	Robert J. Best	2	12/16/99
Letter	Richard F. Friedman	2	12/22/99
Memo	C. R. Trieschman	4	1/7/00
Testimony	Paul Stringer	1	1/12/00
Letter	Janice Sachen	1	1/12/00
Testimony (criteria for district designation)	Brad White	6 (+5)	1/13/00
"Criteria for designation" (resume, excerpt)	Brad White	6 (+2,3)	1/13/00
Memo and articles on ranch houses	Mary McWilliams	1 (+5)	1/13/00
"Why 2044 Sheridan Rd and other bldgs.."	Mary McWilliams	1 (+24)	1/13/00
Memo about Dr. C.W. Westfall	Mary McWilliams		1/13/00
Testimony	Margarita Matlis	2	1/13/00
Testimony	Melinda Pierce	3	1/13/00
Letter	Eugene S. Sunshine, NU Senior V. P.	6	1/13/00
Written Statement Regarding Evanston Pr	Evanstonians for Responsible Preserva	1(+51)	1/13/00
Testimony	Arnold Lau & Ruby Bullen	2	1/13/00
Testimony	Bonnie K. Wefler	1	1/13/00
Testimony	Robert E. Janes	2	1/13/00
Testimony	Melinda Pierce	3	1/13/00
Testimony	Rachel E. Golden	2	1/13/00
Testimony (and excerpt from Comp Plan)	Tom McMahon	2 (+15)	1/13/00
Testimony	Barbara Mortensen	1	1/13/00
Letter (comments on NEHD, Westfall CV)	Northwestern University	6 (+38,16)	1/13/00
Hearing Transcript	Denise Andras	117	1/13/00
Letter	Robert F. Perille	1	1/19/00
Letter	William and Rachel Galer	1	1/20/00
Memo	C. R. Trieschman	1	1/25/00
Memo about Dr. Westfall's commentary	Brad White	2	1/26/00
Memo	William O'Neil & Rosemary O'Neal	1	1/26/00
Directory of Petitions Against the Local N	Evanstonians for Responsible Preserva	6(+3)+	1/26/00
Written Statement Summarizing Presentati	Evanstonians for Responsible Preserva	15	1/26/00
Hearing Transcript	Denise Andras	107	1/26/00
Testimony	Dewey Community Conference	2	1/27/00
Memo (Response to Submission from Nor	Brad White	2	1/27/00
Letter	Brad White	2	1/28/00
Letter to C.R. Trieschman	J. Kirk Irwin	1	1/28/00
Letter	Alfred & Nancy Allred	1	1/31/00
Testimony	Paula Twilling & David Cherry	1	1/31/00
Agenda EPC Meeting	Preservation Commission	1	2/1/00
Letter (Response to Petitions Submitted in	Judy Fiske, NEHDA	3(+77)	2/1/00
Letter (Descriptions of Historic Districts i	Judy Fiske, NEHDA	1(+21)	2/1/00
Memo (Written Statement Regarding Evan	Mary McWilliams	3	2/1/00
Memo (District Size)	Jean Kamps Lindwall (NEHDA)	2	2/1/00
Letter (and petition, Pres. Ord. excerpt, E	Bradford White & Raymond Tatum	4 (+11)	2/1/00
Directory of Petitions Against the Local N	Evanstonians for Responsible Preserva	9	2/1/00
Memo	Mike Ward, IHPA	1	2/1/00

Document Type or Title	From	Pages (+Attachments)	Date
er (remarks by Westfall, plat survey, re	Northwestern University	2 (+8)	2/1/00
Deliberation Transcripts	Denise Andras	180	2/1/00
Letter (via fax)	Robert Best	2	2/2/00
Fax Letter	Ann K. Adams	1	2/2/00
Letter	Judy Fiske, NEHDA	1	2/3/00
Letter	J. Kirk Irwin	1	2/3/00
Deliberation Transcripts	Denise Andras	27	2/8/00
Preservation Commission Special Meeting	Bernadette Haupt	10	3/6/00
Resolution	Preservation Commission	3	3/6/00
Certificate of Mailing	Carlos D. Ruiz (Preservation Coordinat	1+	3/10/00
Information Sheet	Evanston Preservation Commission	4	no date shown
"Remuddling" (photos and text)	James D. McWilliams	22	no date shown
"Criteria for determining critical features i	Mary McWilliams	5	no date shown
Memo	Sarosh Saher, urban design spec.	3	no date shown
Text from slide presentation (and attachm	Jackie McGuire	4 (+2)	no date shown
Pictures	Northwestern Neighbors-Jackie McGu	16	no date shown
Pictures (Chicago Historic District)	NEHDA	8	no date shown
Pictures (Northeast Evanston Local Histo	NEHDA	13	no date shown
Testimony	Jean Nerenberg	1	no date shown
"Three secrets for retaining high-quality st	James D. McWilliams	1	no date shown
Testimony	Susan Laws	1	no date shown
"Response to submission from Northwest	Raymond T. Tatum	10 (+6)	no date shown
Testimony	Ann McMahan	9	no date shown
List of ERP members	Evanstons for Responsible Preservatio	2	no date shown
ee Exhibits (not identified)			no date shown
Exhibit (Zoning Ordinance excerpt)	William O'Neil	3	no date shown
Testimony	Daniel Schwartz	5	no date shown
Testimony	David Cella	2	no date shown
Testimony	Ruth Ann Hladish	1	no date shown
Statement	Sara Webb Phillips	1	no date shown
Testimony	Ruth Winter	1	no date shown
Testimony	Frank Steinberg	1	no date shown
Testimony (and Ev Preservation Plan excerpt)		1 (+4)	no date shown

