

ROBERT CROWN COMMUNITY CENTER ICE COMPLEX AND LIBRARY



EXISTING SITE PLAN



PROJECT HISTORY

1974

Robert Crown Center Opens

- Project Funded via Grant by Robert Crown Family
- Funded by the City of Evanston
- Total Cost \$2.5 million

2003

City conducts a thorough Building Assessment

- Finds significant infrastructural needs
- Maintenance Deferred at that time

2009

City explores Design-Build-Operate-Finance public/private partnership solution

- Two Finalists identified
- Total projects identified are cost prohibitive due to:
 - Private Financing Costs are nearly 2x City costs (interest rate for borrowing)
 - City would still be responsible if default

PROJECT HISTORY

2013 City explores options/costs of a New Building vs Renovations+Addition

- Produces initial cost estimates of:
 - \$18 million for renovation + new Turf field(s)
 - \$30 million for new facility (two full size ice sheets)
- Recommends public/private funding to limit total debt incurred by City for new facility

2015 Initial Steps

- CCS Fundraising firm hired to conduct feasibility study
- Study determines \$3-5 million could be raised
- 18-24 month fundraising timeframe

PROJECT HISTORY

2016

Action Steps

- Friends of Crown 501c3 Formed
- Fundraising Campaign Approved
- RFP Seeking Architectural Services for the design and construction

2017

Activities

- Fundraising moves into public phase
- Public discussion of Center design and location
- Construction drawings.



ROBERT CROWN COMMUNITY CENTER ICE COMPLEX AND LIBRARY

WTA+MJMA
Woodhouse Tinucci Architects MacLennan Jaunkalns Miller Architects

OVER 25 YEARS OF COMMUNITY AND PARK DISTRICT EXPERIENCE



ALMOST 30 YEARS FOCUSED ON MULTI-USE COMMUNITY REC

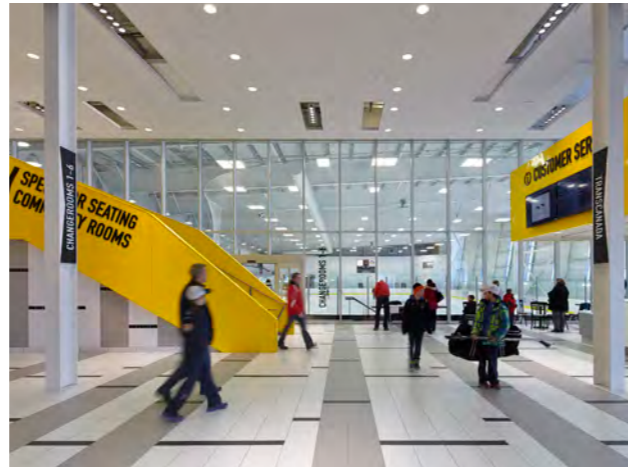

SPORTSFIELDS AND PARK SITES

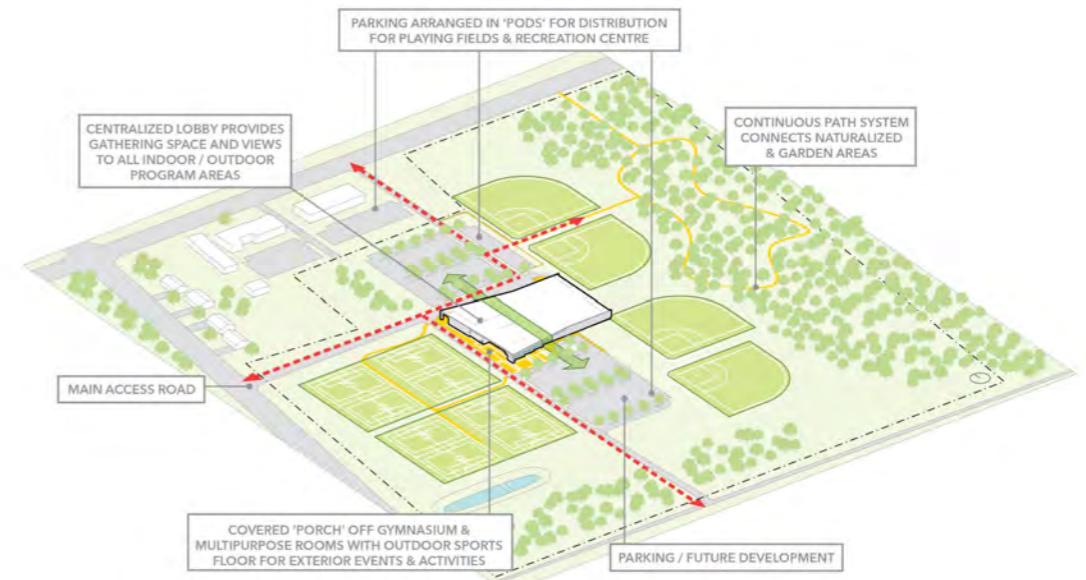
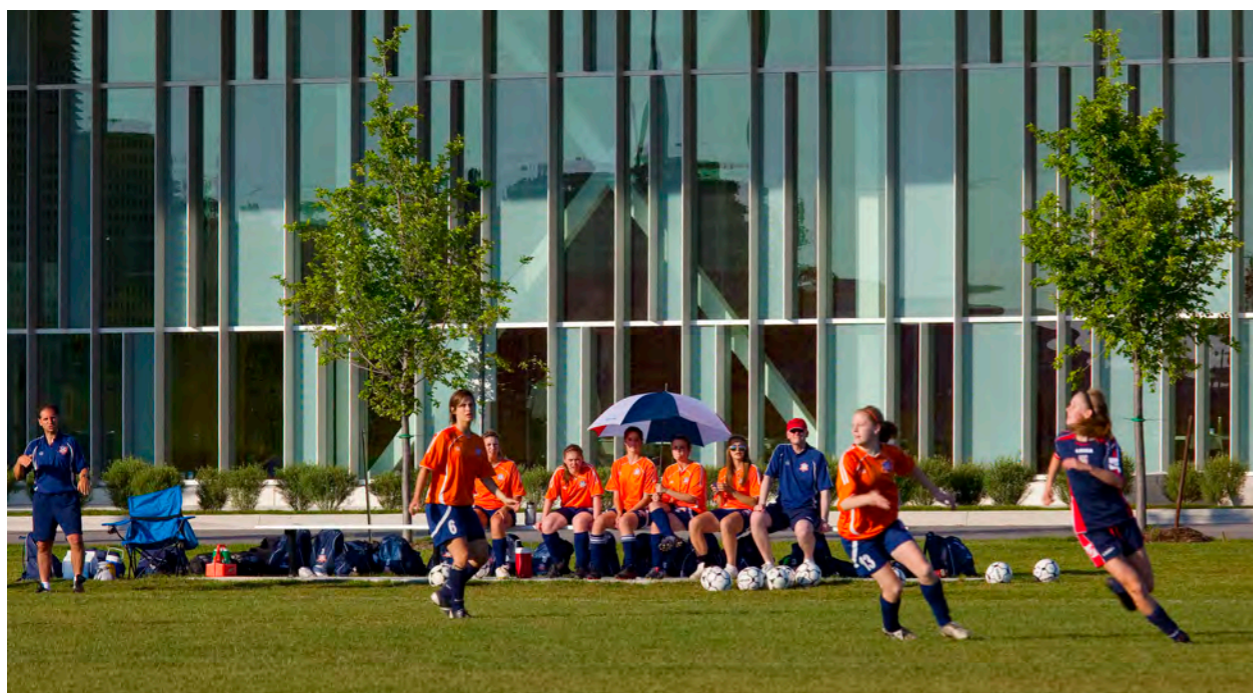
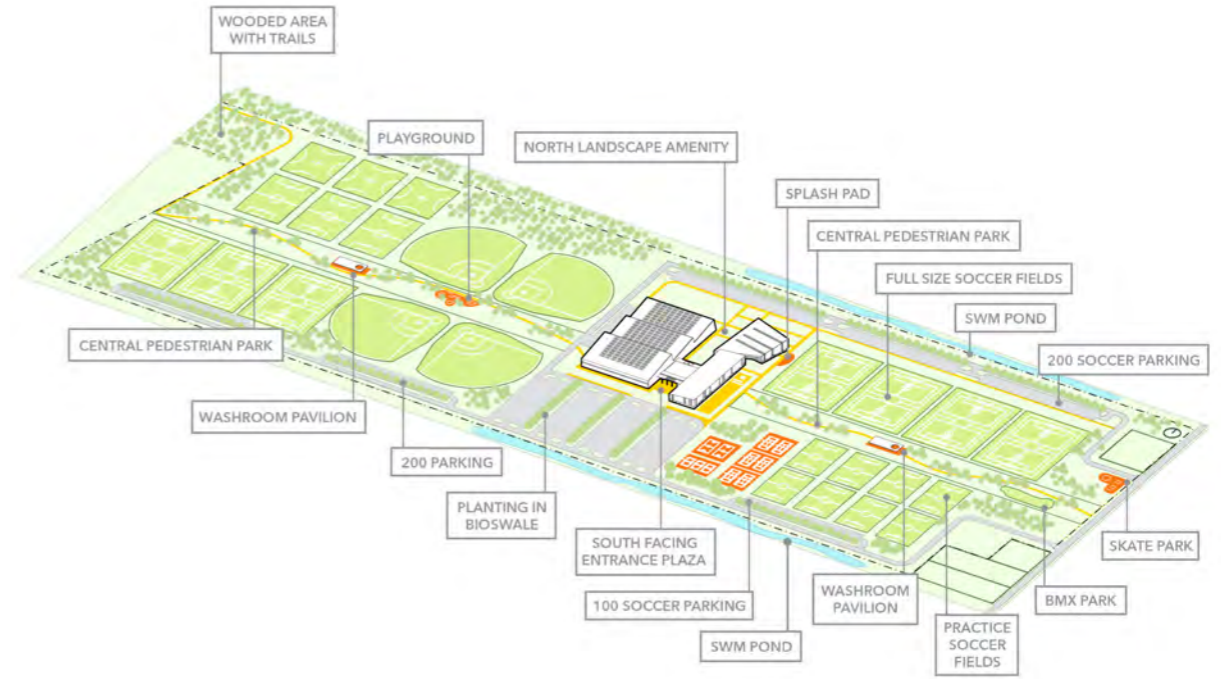

OVER 12 COMBINED COMMUNITY RECREATION / BRANCH LIBRARIES

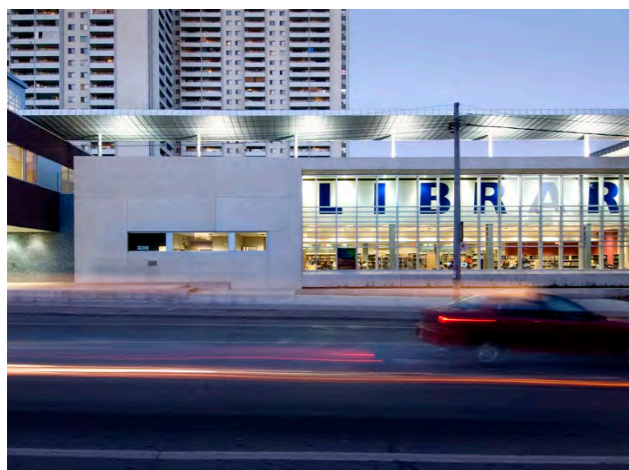
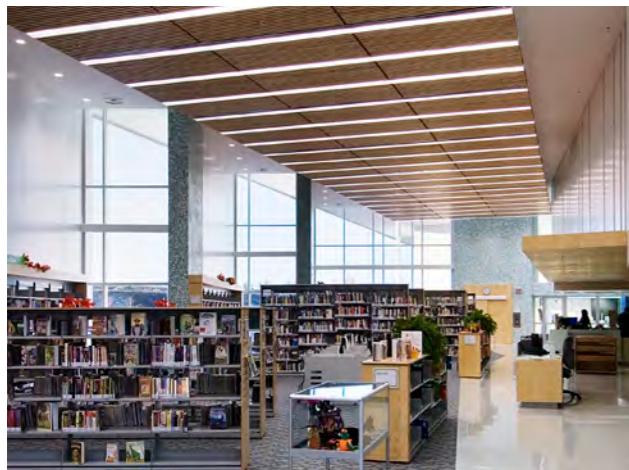

REAL PROJECTS FOR REAL MUNICIPALITIES



ATLAS TUBE CENTER & LIBRARY



AUDLEY COMMUNITY CENTER & LIBRARY



VALE HEALTH & WELLNESS CENTER



WOOLWICH MEMORIAL CENTER



INNISFIL RECREATION COMPLEX



SW COMMUNITY CENTRE & LIBRARY



BESSARION COMMUNITY CENTER & LIBRARY



SHERWOOD COMMUNITY CENTRE & LIBRARY

PUBLIC PROCESS

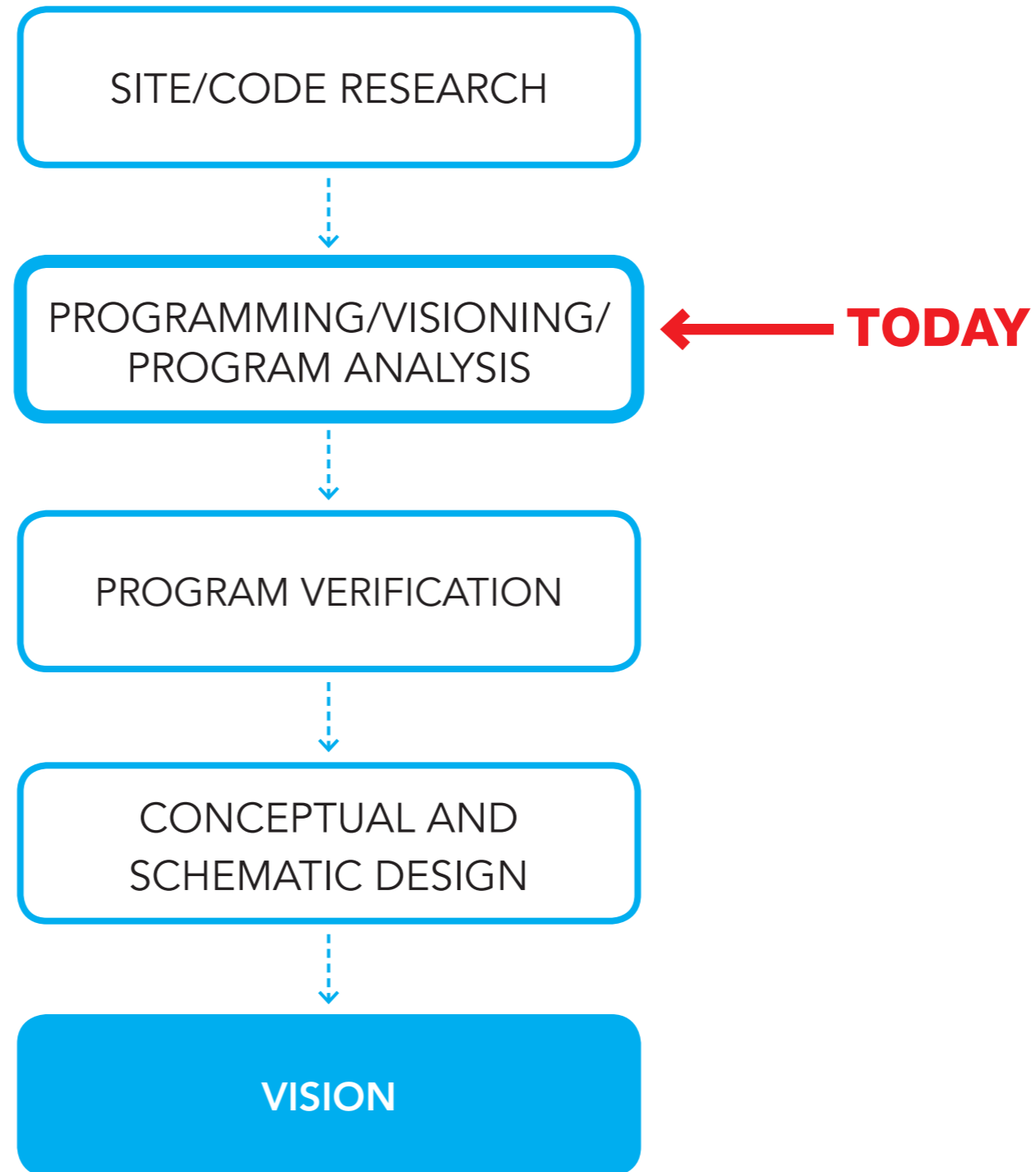

A COMMUNITY IN SUPPORT OF A COMMUNITY CENTER

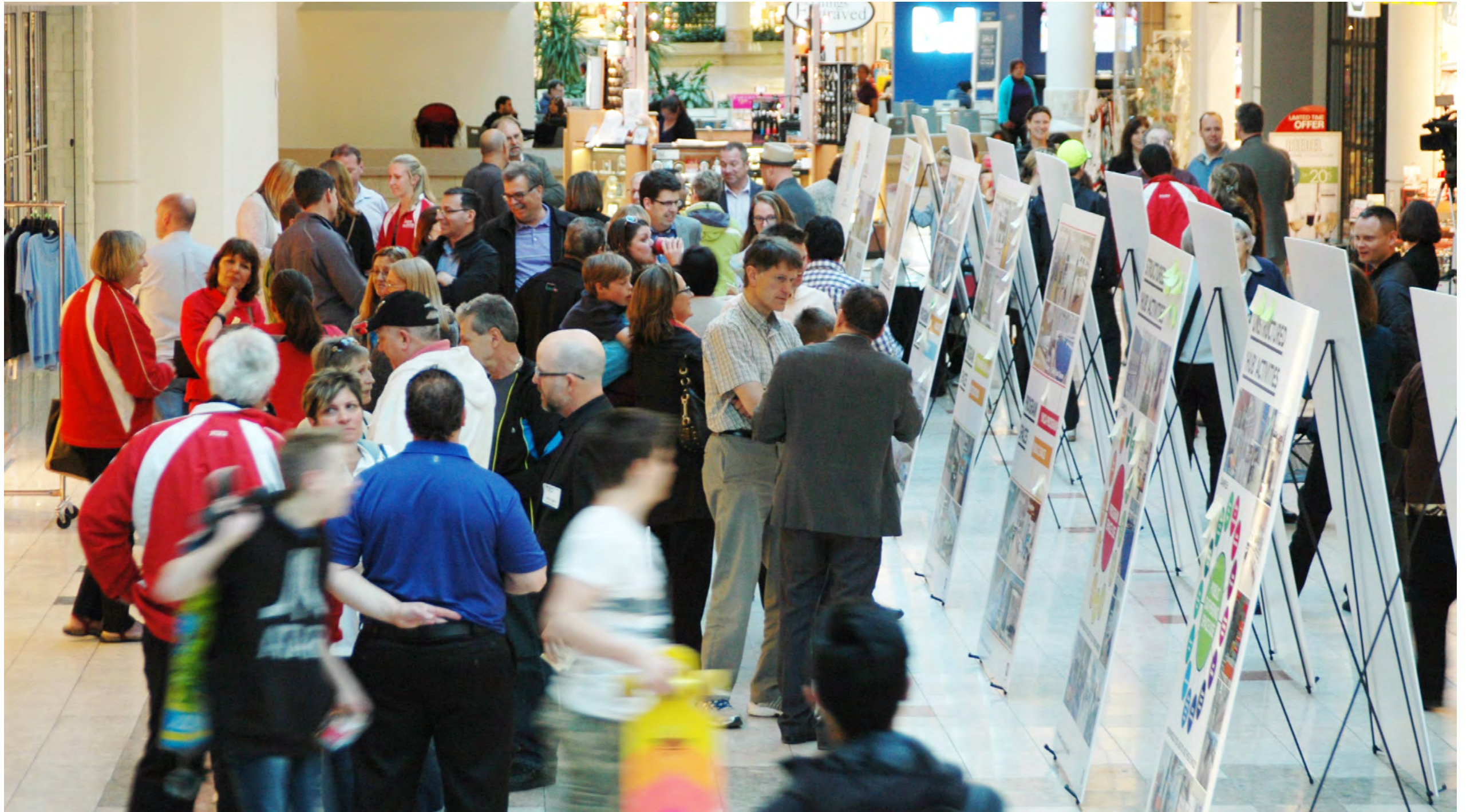

CREATE AN ICONIC NEIGHBORHOOD LANDMARK



FOR ALL AGES AND ABILITIES



TO MEET, PLAY, LEARN



NATURAL LIGHT TO ALL SPACES



OPEN AND INVITING FOR THE ENTIRE COMMUNITY



SUSTAINABILITY



LIBRARY INTEGRATED BUT WITH OWN IDENTITY

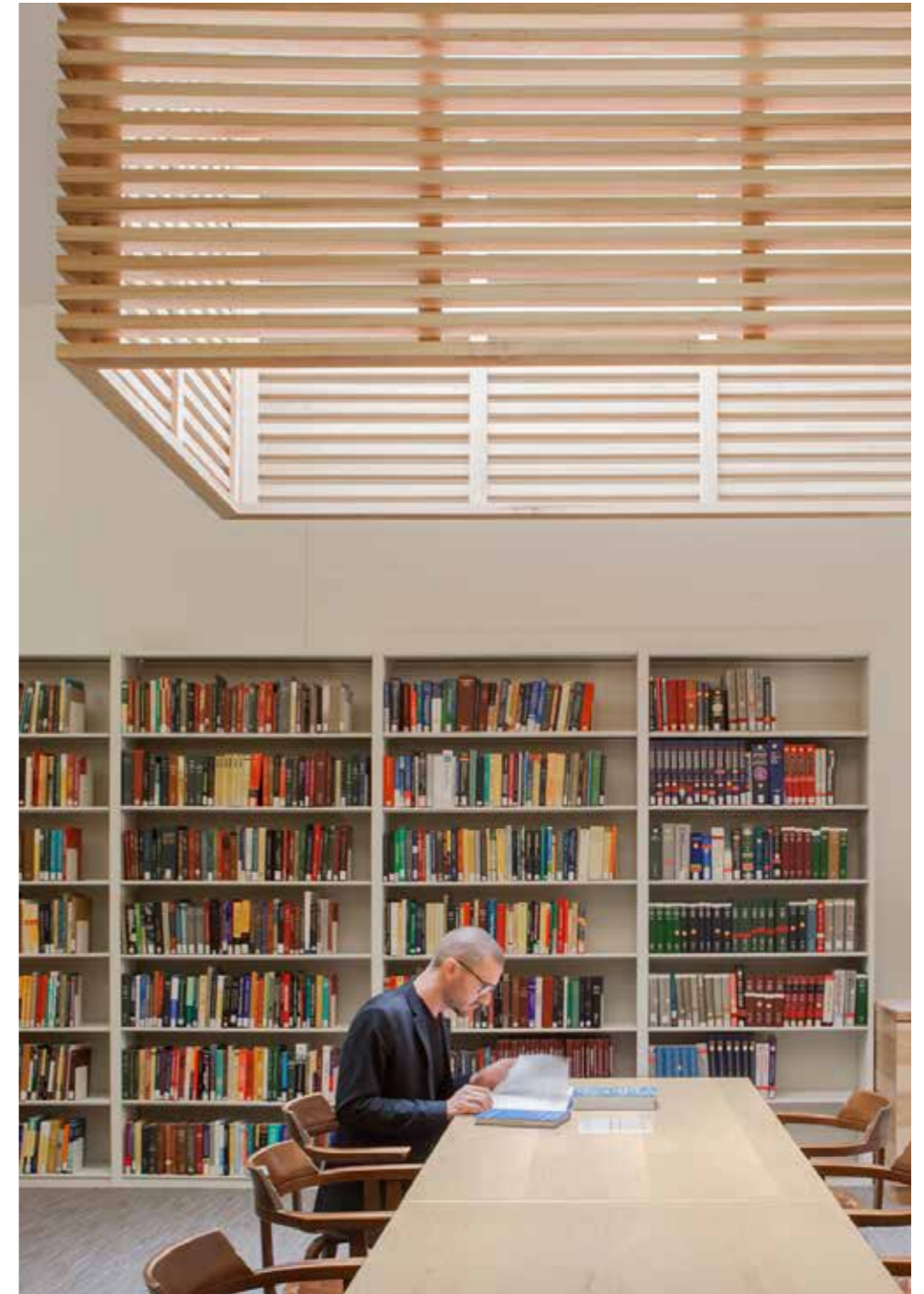

LOBBY SPACE AS CIVIC HEART



FLEXIBILITY OF PROGRAMMING



DIGITAL CENTER

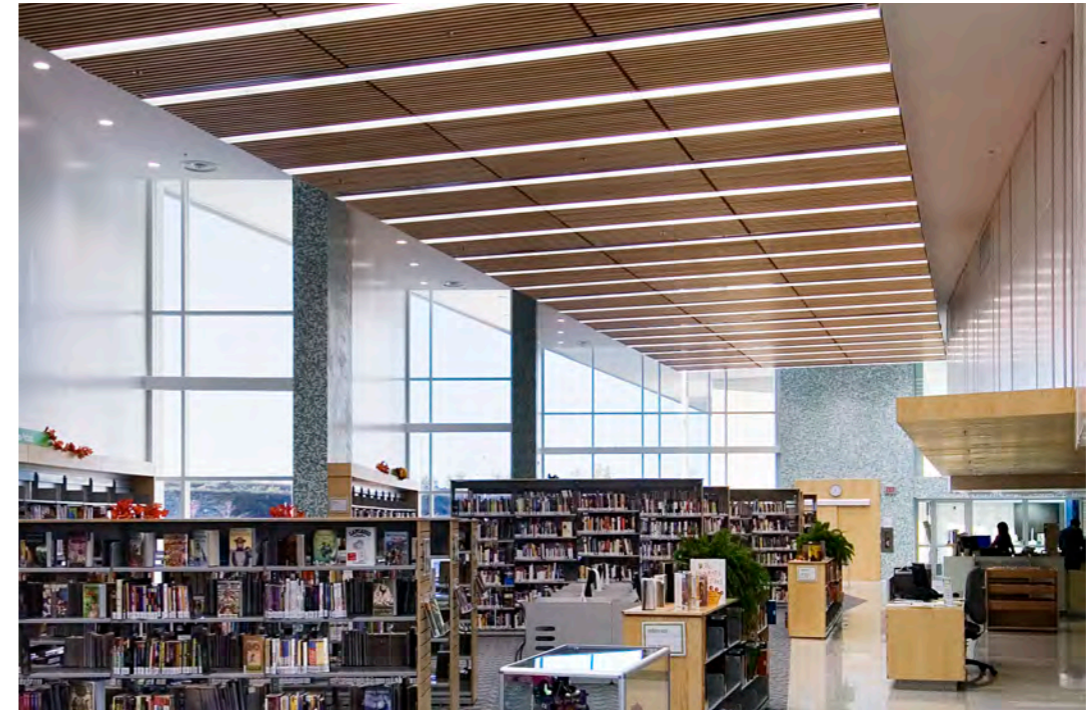

FLEXIBLE STACKS



SPACES FOR ALL AGES



COLLABORATION

ADDRESS THE NEIGHBORHOOD AND THE PARK



RE-IMAGINE PARKING

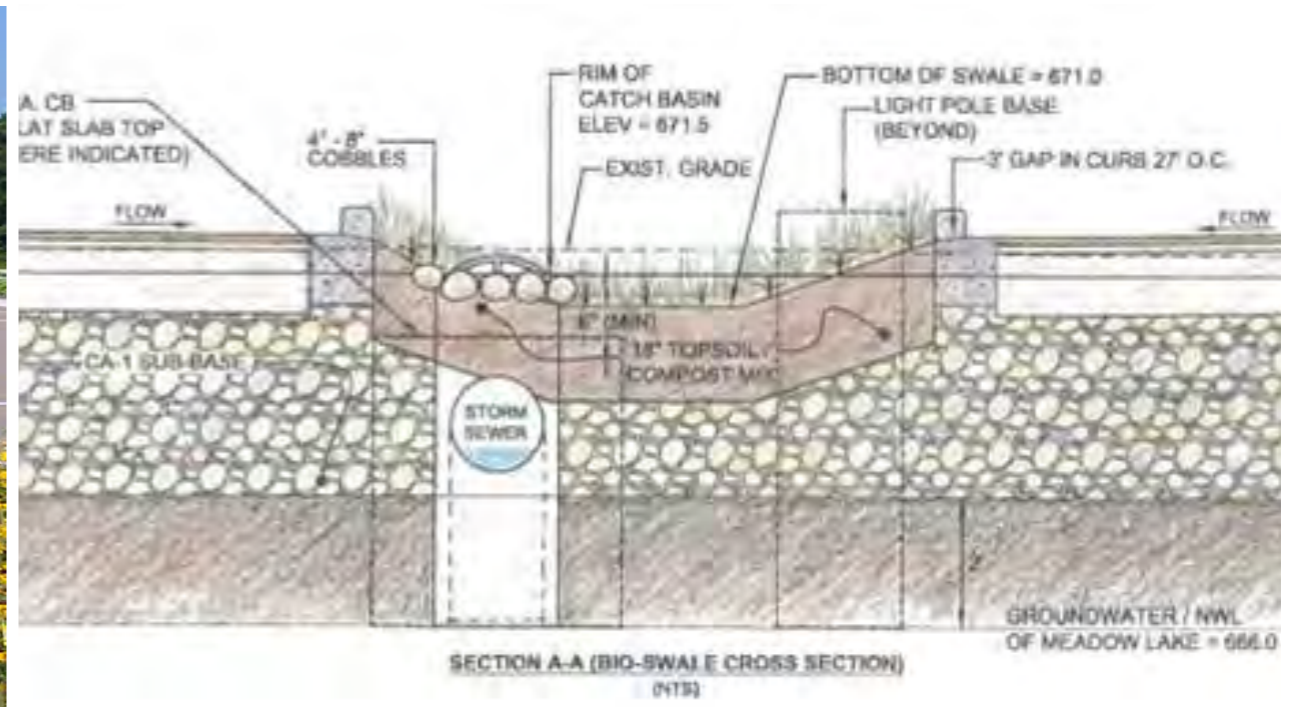

EXTEND PROGRAM OUTDOORS



PROJECT PROGRAM

ICE RINK	SF	SITE	SF
RINK 1 (OLYMPIC)	24,000	BUILDING FOOTPRINT (APROX)	100,000
RINK 2 (NHL)	22,000	PARKING	120,000
SPECTATORS	8,000	SPORTS FIELDS	300,000
LOCKER ROOMS	6,500	LANDSCAPE/OTHER	200,000
SUPPORT	6,500	SITE TOTAL	720,000
	67,000		
RECREATION			
GYMNASIUM	11,000		
FITNESS ROOM	2,000		
SUPPORT	2,600		
	15,600		
LIBRARY			
LIBRARY	3,300		
MEETING ROOMS	600		
SUPPORT	1,120		
	5,020		
COMMUNITY CENTER			
MULTI-PURPOSE	3,000		
PRE-SCHOOL	2,000		
DANCE	1,000		
SUPPORT	3,500		
	9,500		
SUBTOTAL	97,120		
TRACK	5,000		
SOCIAL SPACE/CIRCULATION	12,255		
INFRASTRUCTURE/MECHANICAL	13,725		
BUILDING TOTAL	128,100		

PROGRAM AND PROGRAM DIAGRAMS

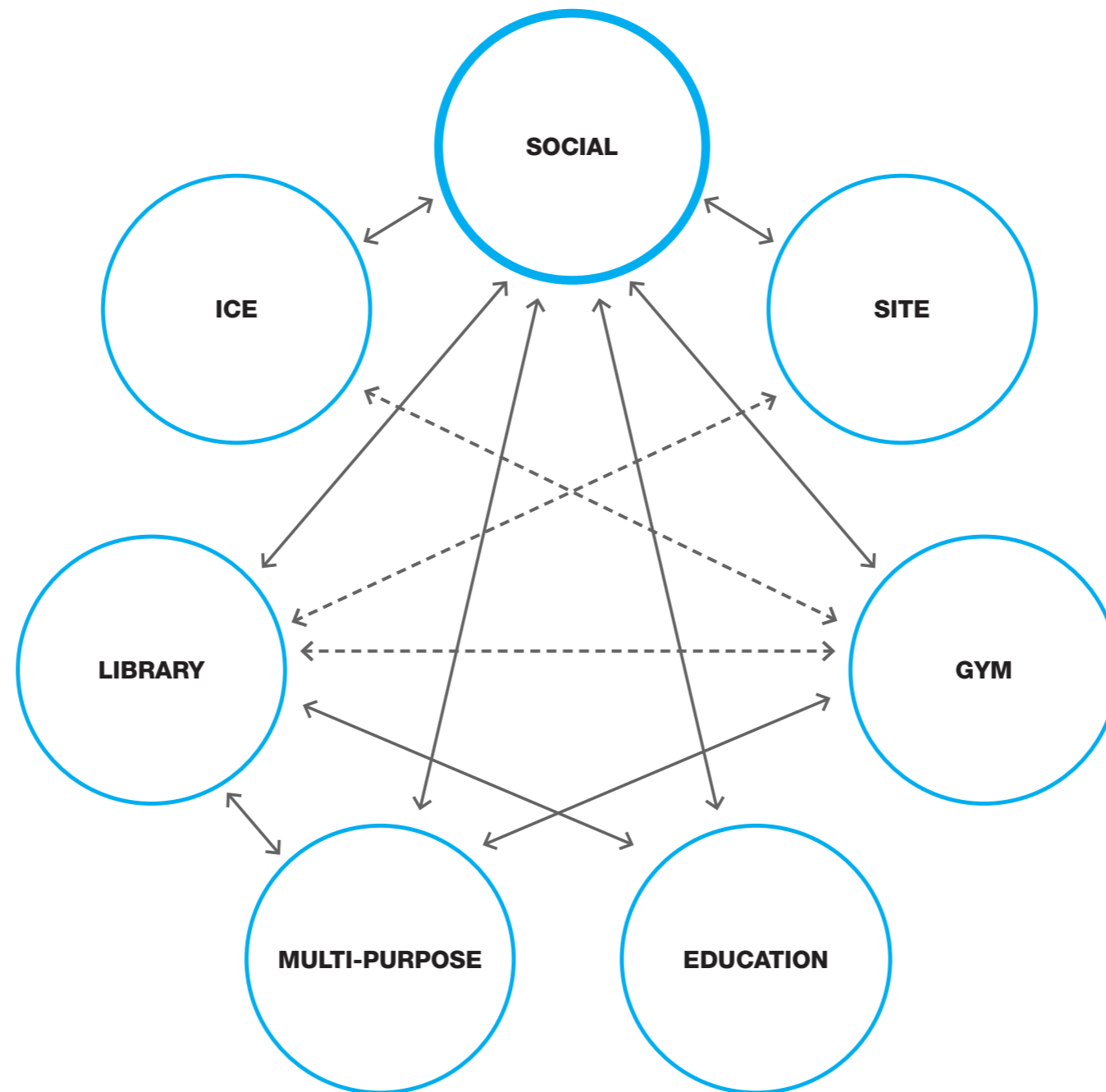

PROGRAM AND PROGRAM DIAGRAMS

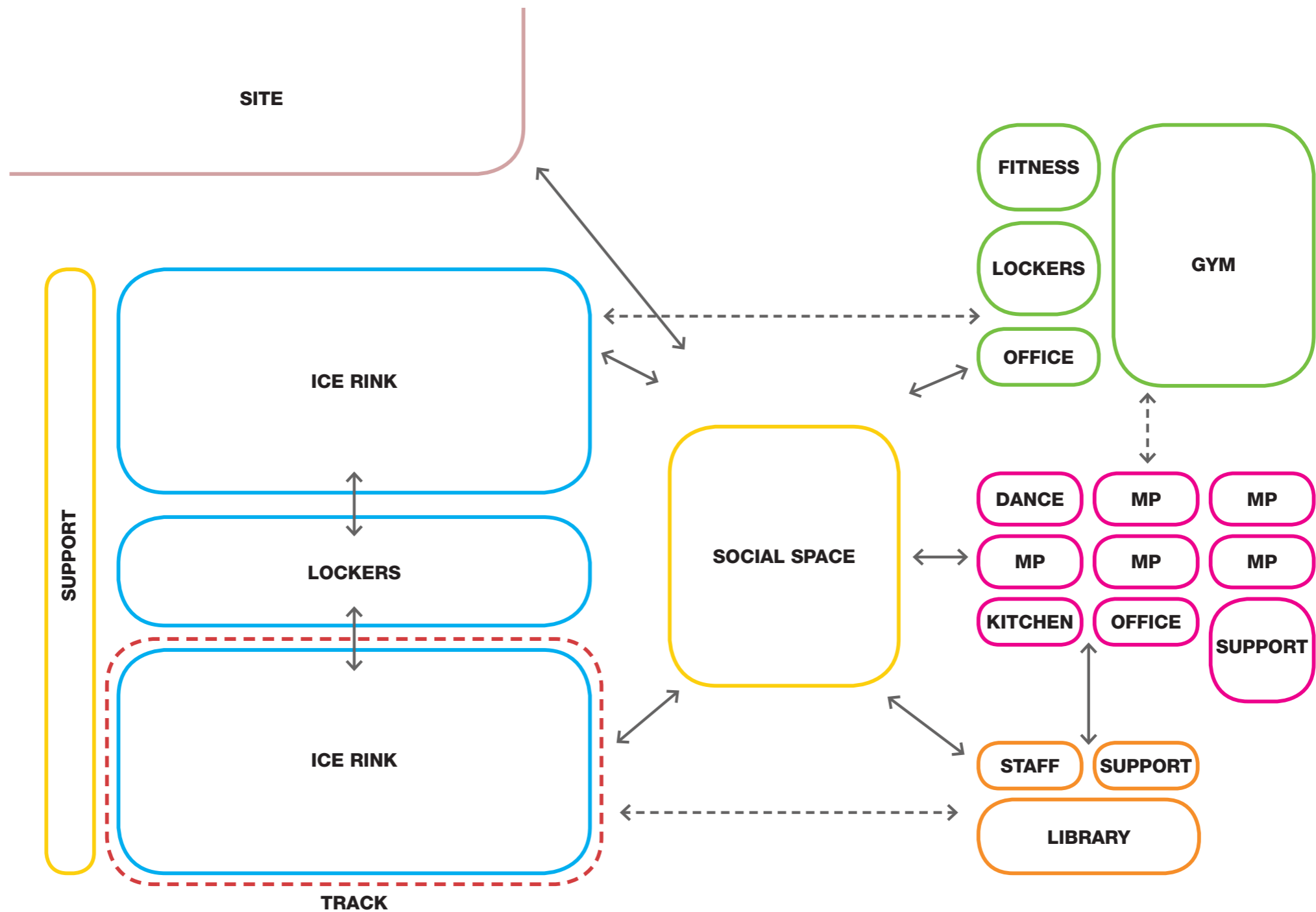

LIBRARY



BOOKS FOR ALL AGES



VISUAL CONNECTION TO OUTSIDE



JOB TRAINING



AFTER-HOURS SERVICE



CHILDREN'S AREA



AFTER SCHOOL PROGRAMS



DIGITAL CENTER



YOUTH SERVICES



INFORMAL SPACES

COMMUNITY CENTER



KIDS ACTIVITIES



ART PROGRAMS



MEETING SPACE



PRE-SCHOOL



LINK TO OTHER PROGRAM SPACE



COMMUNITY ROOMS



EXTERIOR PROGRAMMING



KITCHEN



SOCIAL + EVENT SPACE

PRE-SCHOOL



MULTI-PURPOSE ROOMS

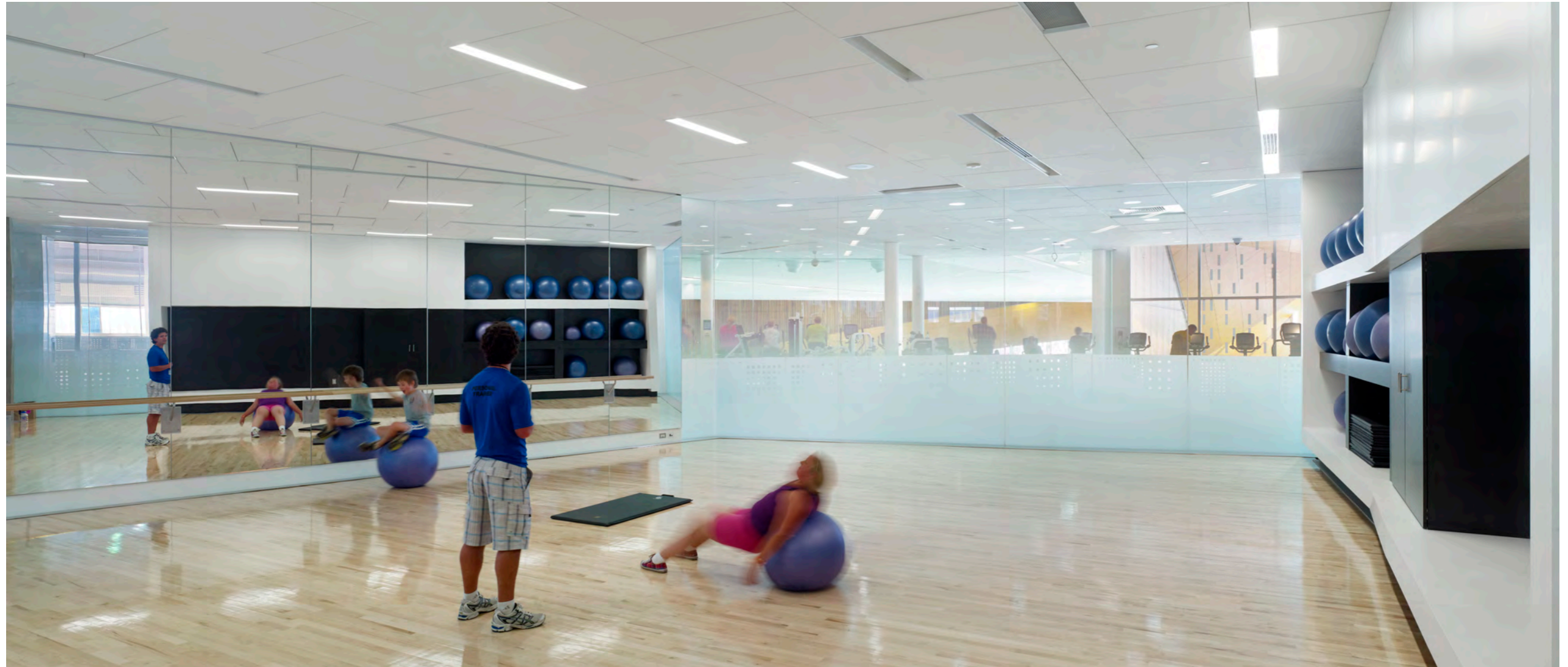

KITCHEN



GYMNASIUM AND RECREATION



GYMNASIUM



TEAM ACTIVITIES



DANCE | YOGA



WELLNESS + TRAINING



VISUAL CONNECTION TO OUTSIDE

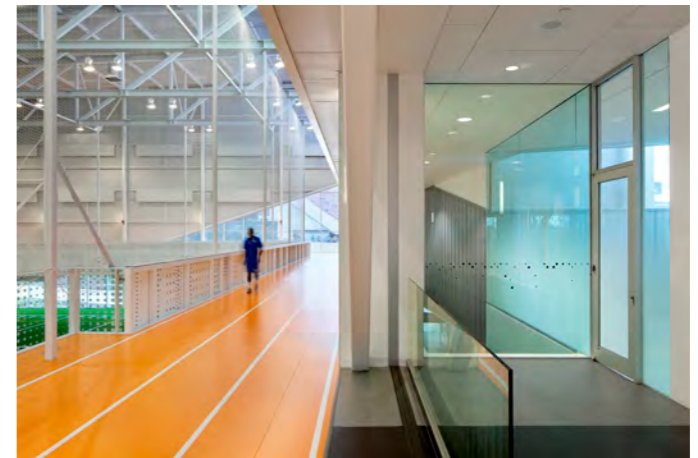

WALKING + RUNNING TRACK



VIEWS INTO PROGRAM



CHANGING ROOMS | LOCKERS



MULTI | EXTENDED USE

TWIN PAD ICE ARENA



HOCKEY



WARM SIDE VIEWING



LESSONS

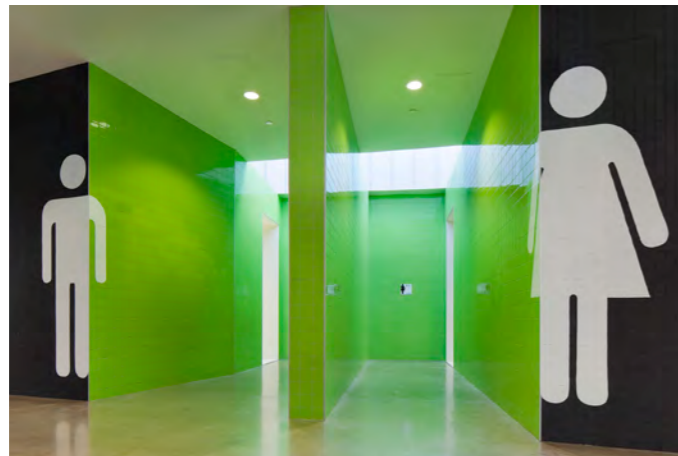

LOCKER | CHANGE ROOMS



SLED HOCKEY



TRACK



SPEED SKATING



FIGURE SKATING



SPECTATOR VIEWING

OUTDOOR ATHLETICS



AFTER SCHOOL PROGRAMS



SPECTATOR SPACE



SOCCER



NIGHT PROGRAMMING



BASEBALL / SOFTBALL



OUTDOOR FITNESS PATHS



FOOTBALL



TENNIS



LACROSSE

COMMUNITY INTERESTS



ARRIVAL / RECEPTION



CLEAR CIRCULATION



MULTIGENERATIONAL ACTIVITIES



EVENT + RENTAL OPPORTUNITIES



OPEN SPACE



SUSTAINABLE PARKING



SHADED OUTDOOR SEATING



COMMUNITY EVENTS



SECURE BIKE RACKS

PROJECT SCHEDULE

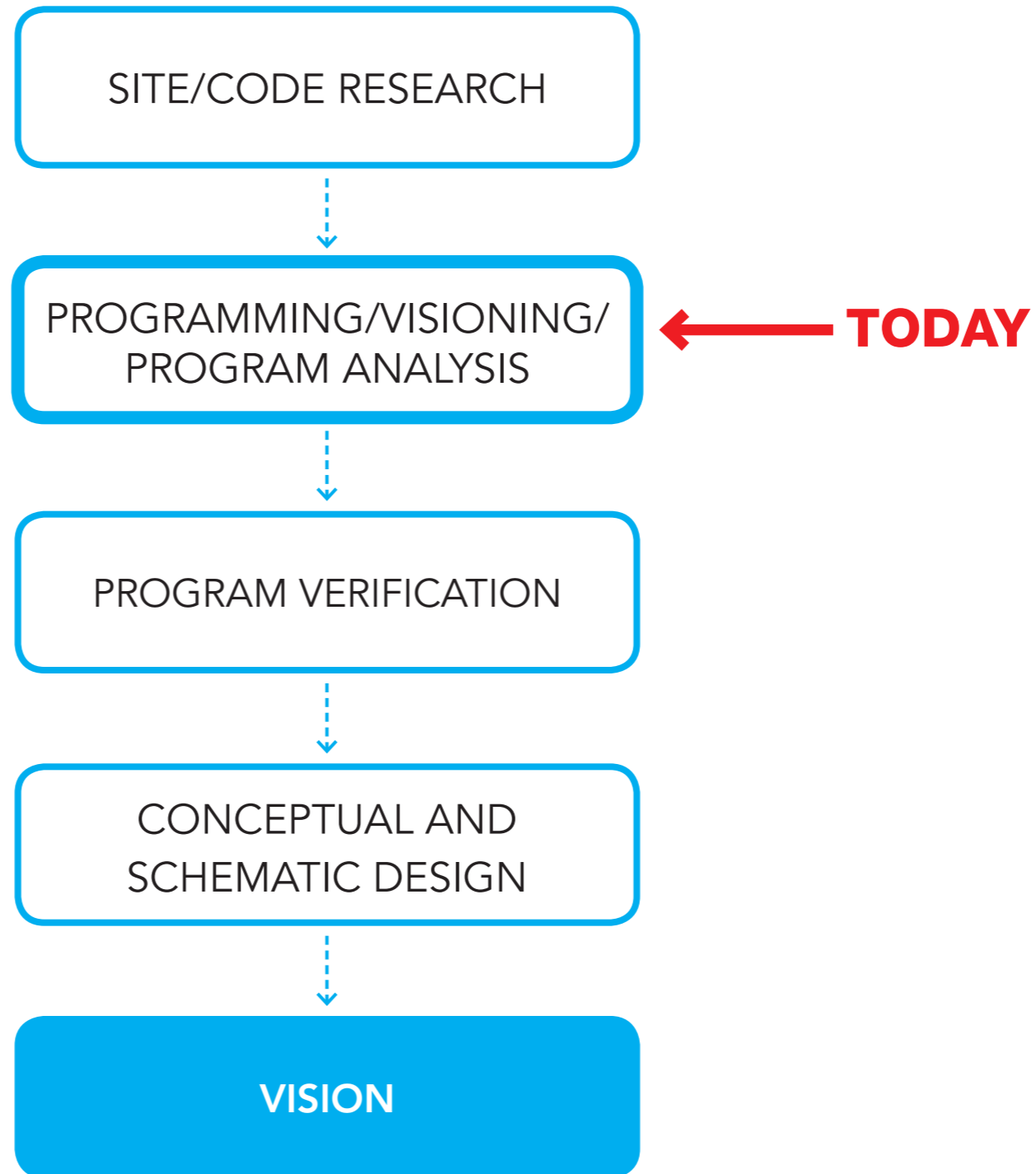

PROJECT SCHEDULE

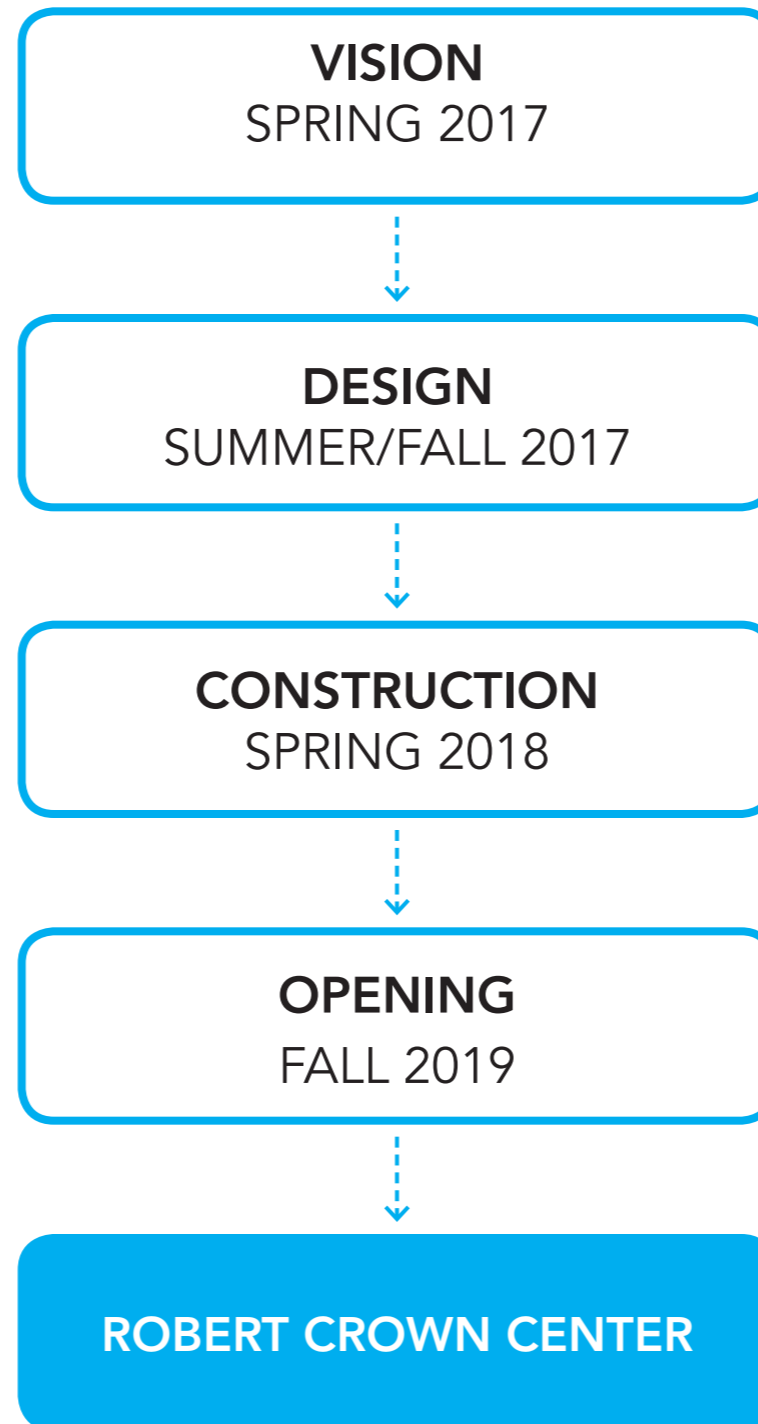



WTA+MJMA
Woodhouse Tinucci Architects MacLennan Jaunkalns Miller Architects